

MECHANICAL ROOM GENERAL NOTES:

- REFER TO MECHANICAL / PLUMBING / ELECTRICAL DRAWINGS FOR EQUIPMENT LAYOUTS AND CONCRETE EQUIPMENT PAD REQUIREMENTS, TYP.
- PROVIDE FLOOR DRAINS AND SLOPE FLOOR TO DRAIN. COORDINATE DRAIN LOCATIONS WITH PLUMBING DRAWINGS.

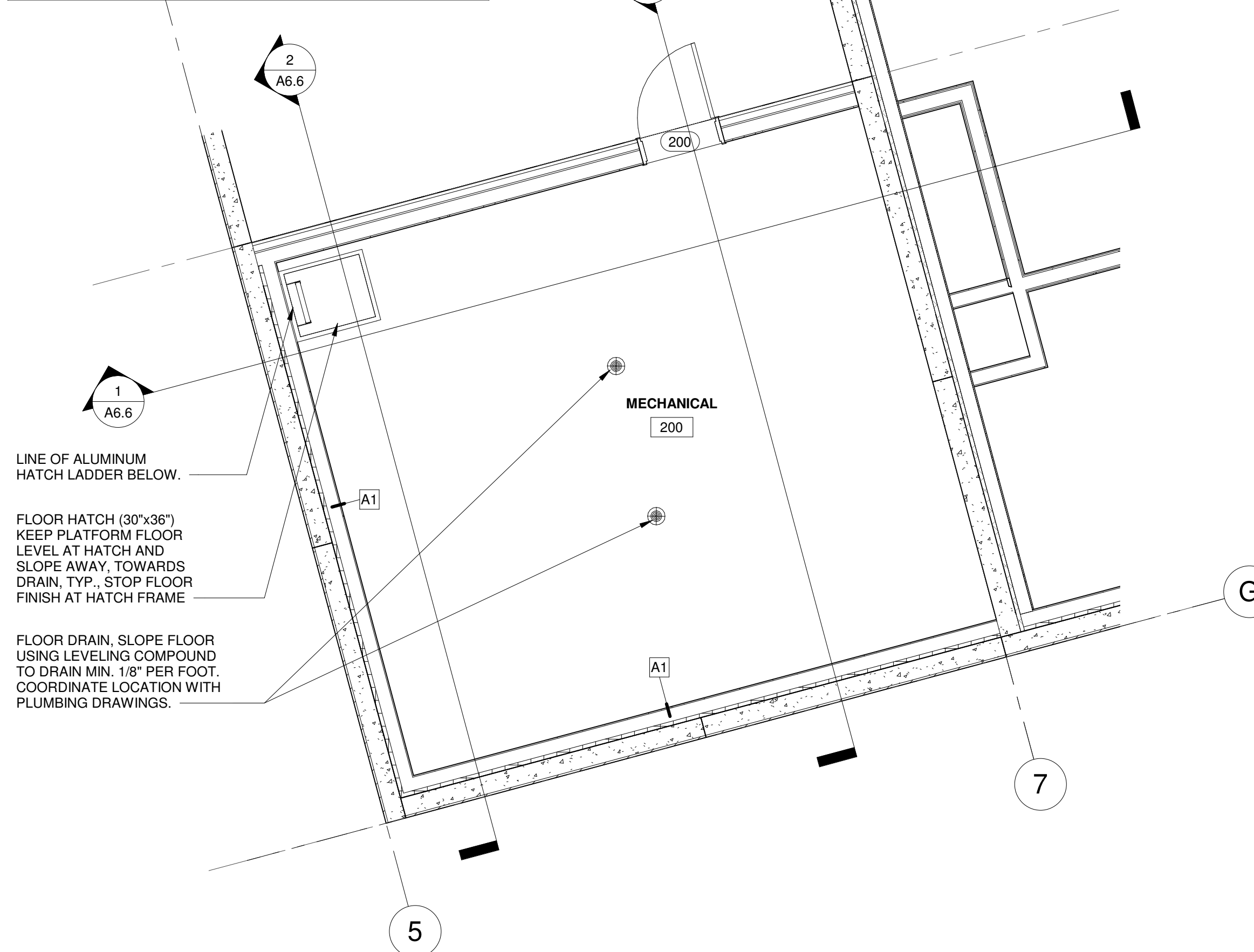

1 FLOOR PLAN
1/8" = 1'-0"

DEMOLITION SCHEDULE

STEP 1: INSTALLATION OF SIDEWALK AT THE SOUTH CURTAINWALL. REFER TO CIVIL DRAWINGS.

STEP 2: REMOVAL OF DOORS FROM EAST CURTAINWALL AND RELOCATION TO THE SOUTH CURTAINWALL.

STEP 3: REMOVAL OF EAST CURTAINWALL IN ENTIRETY AND INSTALLATION OF A TEMPORARY PARTITION KEEPING THE BUILDING WATER TIGHT.

TEMPORARY PARTITION CONSTRUCTION:

- 16 GA. STEEL STUDS @ 16" O.C. EXTENDING TO BOTTOM OF DECK.
- 1 LAYER OF 5/8" TYPE 'X' GYP. BOARD ON EACH SIDE. EXTEND TO BOTTOM OF DECK.
- 3/4" EXTERIOR FIRE-RETARDANT-TREATED PLYWOOD SHEATHING EXTENDING TO BOTTOM OF DECK AT EXTERIOR SIDE OF PARTITION.
- WATERPROOFING MEMBRANE / WRAP ON PLYWOOD SHEATHING.

NOTE: TEMPORARY PARTITION (NONBEARING WALL) TO HAVE A 1HR FIRE RATING BASED ON IBC 2015 TABLES 601 AND 602. UL 1419.

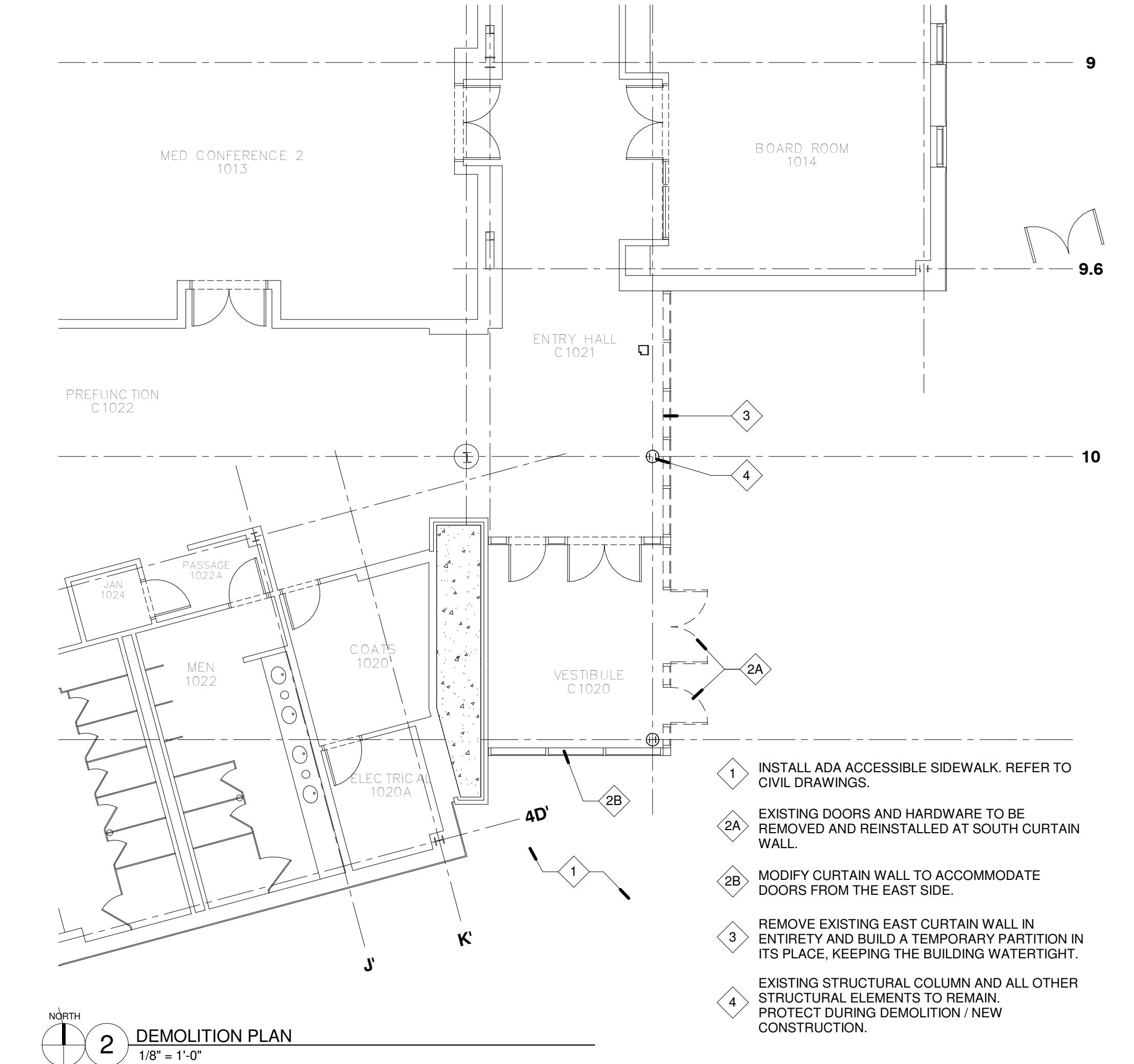

2 DEMOLITION PLAN
1/8" = 1'-0"

- INSTALL ADA ACCESSIBLE SIDEWALK. REFER TO CIVIL DRAWINGS.
- EXISTING DOORS AND HARDWARE TO BE REMOVED AND REINSTALLED AT SOUTH CURTAIN WALL.
- MODIFY CURTAIN WALL TO ACCOMMODATE DOORS FROM THE EAST SIDE.
- REMOVE EXISTING EAST CURTAIN WALL IN ENTIRETY AND BUILD A TEMPORARY PARTITION IN ITS PLACE, KEEPING THE BUILDING WATER TIGHT.
- EXISTING STRUCTURAL COLUMN AND ALL OTHER STRUCTURAL ELEMENTS TO REMAIN. PROTECT DURING DEMOLITION / NEW CONSTRUCTION.