

A DIVISION OF SHIVE-HATTERY INC.

DESIGN ORGANIZATION
Planning | Architecture | Engineering | Interior Design

440 North Wells | Suite 320
Chicago, Illinois 60654 | 312.324.5500
www.designorg.com

PLAN LEGEND

- ROOM NUMBER
- DOOR TAG
- WINDOW TAG: SEE WINDOW ELEVATIONS
- KEYNOTE TAG
- PARTITION WALL TYPE TAG
- REVISION INDICATION W/ REVISION NUMBER
- DETAIL NUMBER SHEET NUMBER
- BUILDING SECTION MARK: DETAIL NUMBER SHEET NUMBER
- SECTION MARK: DETAIL NUMBER SHEET NUMBER
- ELEVATION MARK: SHEET NUMBER DETAIL NUMBER

KEYNOTES

- 03.07 NEW CONCRETE RAMP - SLOPE NOT TO EXCEED 1:12
- 04.21 INFILL OPENING TO MATCH EXISTING CMU AND BRICK CONSTRUCTION. FINISH INTERIOR TO MATCH EXISTING
- 05.17 STEEL STAIR WITH CONCRETE PAN TREADS
- 05.19 1-1/2" DIAMETER METAL WALL MOUNTED HANDRAIL - REFER TO DETAILS AND SECTIONS
- 05.24 1-1/2" DIAMETER FLOOR MOUNTED METAL RAIL SOLID SURFACE COUNTERTOP (SS1)
- 06.03 MILLWORK COUNTERTOP AND BASE CABINETS - REFER TO INTERIOR ELEVATIONS
- 06.16 MILLWORK UPPER CABINETS - REFER TO INTERIOR ELEVATIONS
- 06.19 FULL HEIGHT GLASS DISPLAY CASE BY OTHERS - PREFINISHED AND ALUMINUM SCUPPER - REFER TO SPECIFICATIONS
- 07.14 PREFINISHED ALUMINUM GUTTER DRAIN LEADER - REFER TO SPECIFICATIONS
- 08.11 ARCHITECTURAL MECHANICAL LOUVER
- 08.18 OVERHEAD COILING MECHANICAL DOOR - REFER TO SPECIFICATION AND DOOR SCHEDULE
- 08.19 SECURITY TRANSACTION WINDOW
- 08.20 ALUMINUM STOREFRONT ENTRANCE FRAMING WITH 1/4" GLAZING
- 08.22 FLUSH ACCESS PANEL - 24"X24"
- 08.24 BLAST RESISTANT ALUMINUM CURTAIN WALL FRAMING WITH LAMINATED 1" INSULATING GLAZING - REFER TO WINDOW SCHEDULE AND SPECIFICATIONS
- 10.04 RECESSED FIRE EXTINGUISHER CABINET AND FIRE EXTINGUISHER
- 10.05 SURFACE MOUNTED CORNER GUARD
- 10.17 12'-3" TALL PAIRED PANEL OPERABLE PARTITION - REFER TO SPECIFICATIONS
- 10.19 RECESSED WALK OFF MAT
- 10.28 WALL MOUNTED BROOM AND MOP HOLDER
- 10.29 WALL MOUNTED FIRE EXTINGUISHER CABINET
- 11.02 REFRIGERATOR F.O.I.O. - PROVIDE WATER LINE TO THIS LOCATION - REFER TO PLUMBING DRAWINGS
- 11.05 TV MONITOR WITH MOUNTING BRACKET - F.O.I.O. - PROVIDE BLOCKING AS REQUIRED
- 12.02 MILLWORK SECURITY DESK - REFER TO INTERIOR ELEVATIONS
- 14.01 NEW ELEVATOR - REFER TO SPECIFICATIONS
- 22.01 NEW SINK - REFER TO PLUMBING DRAWINGS
- 22.04 MOP BASIN - REFER TO PLUMBING DRAWINGS. PROVIDE FRP PANELS 48" HIGH FULL LENGTH BOTH WET WALLS
- 22.06 HI-LOW DRINKING FOUNTAIN - REFER TO PLUMBING DRAWINGS
- 23.02 RECESSED CABINET HEATER - REFER TO MECHANICAL DRAWINGS
- 23.05 RADIATOR UNIT - REFER TO MECHANICAL DRAWINGS
- 23.06 FAN COIL UNIT - REFER TO MECHANICAL DRAWINGS
- 23.07 CABINET HEATER - REFER TO MECHANICAL DRAWINGS

SET DESCRIPTION	DATE
ISSUED FOR BID	12.14.15

REVISION	DATE

PROJECT NAME
UNIVERSITY OF ILLINOIS AT URBANA - CHAMPAIGN
CERL MAIN BUILDING ADDITION
2902 NEWMARK DR
CHAMPAIGN, IL 61822

SHEET TITLE
FIRST FLOOR NOTE PLAN

PROJECT NO. **7131230**
UNIVERSITY PROJECT NO. **U13024**
SHEET NO. **A131**

SEAL: Thomas C. Longhi, 001-012985, ARCHITECT, STATE OF ILLINOIS

Expires: 11-30-2016

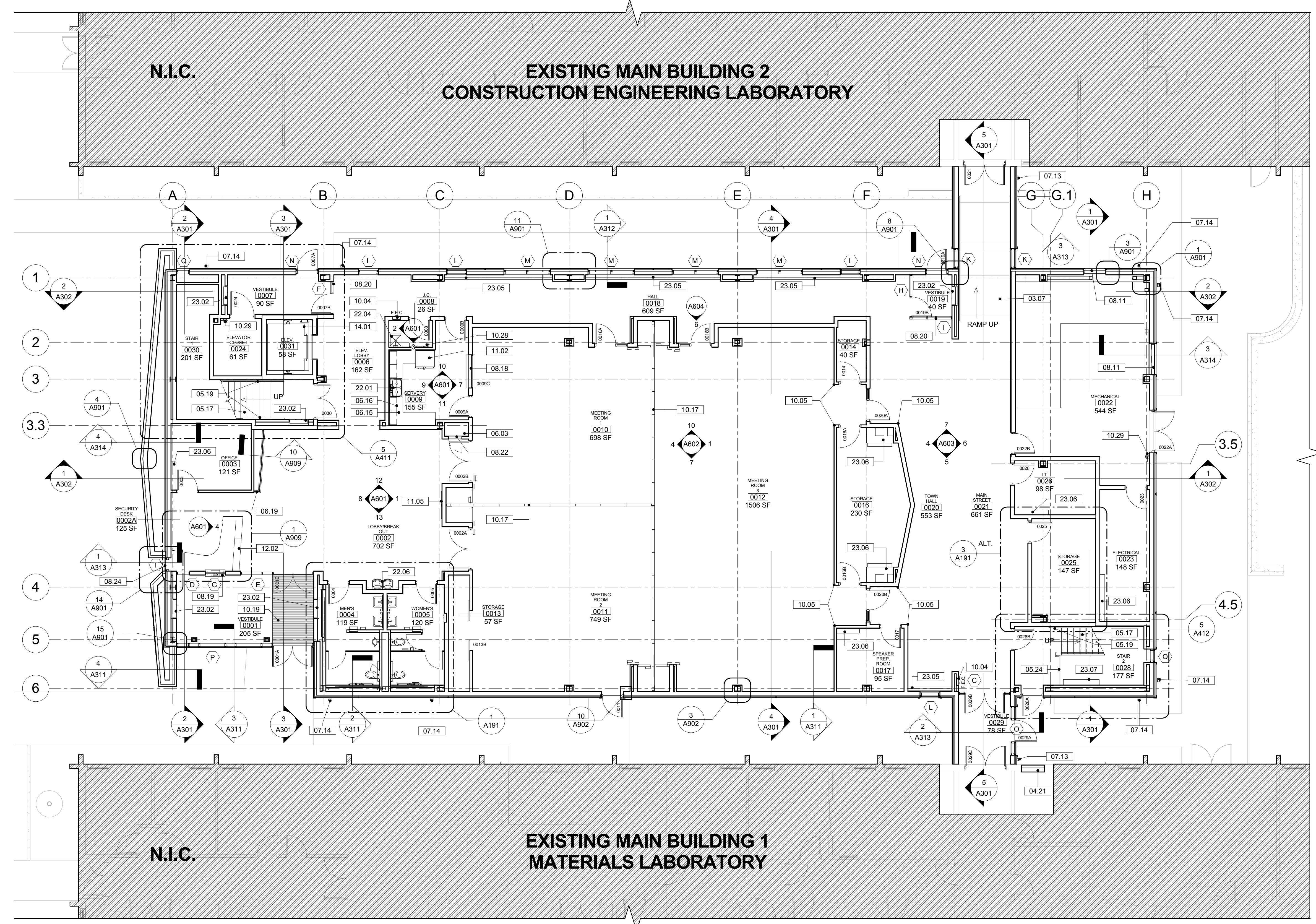

NORTH
1ST FLOOR NOTE PLAN
1/8" = 1'-0"