

SUSTAINABILITY LLC

SHORTS FILM FESTIVAL

2025



Student Affairs

University Housing

Sustainability LLC

- Est. 2012
- 1 of 10 Living Learning Communities
- NRES
- Native Plants (Fall & Spring)
- Ethics and the Environment (Fall '25)
- 7th year of Film Festival

SLLC Shorts Film Festival 2024-25

- 7th season
- Record 1,174 submissions!
- 18 selections, 4 honorable mentions
- 13 countries
 - Austria, Bangladesh, Canada, Columbia, Egypt, France, Indonesia, Italy, Netherlands, Nigeria, Turkey, United Kingdom, United States

New SLLC Course

- NRES 199
- Ethics & the Environment
- 1 credit hour
- Ethics
- Critical Thinking
- Grassroots application

New University of Illinois Course!

NRES 199: Ethics and the Environment

Interested in environmental ethics in both theory and practice?

Sign up for NRES 199 Ethics and the Environment this fall with Dr. Adam Betz!

- Learn about ethical issues of sustainability, critical thinking, & the psychology of persuasion.
- Field trips and volunteer opportunities!
- 1 credit hour
- Thursday 11am – 12:20pm in ISR 94
- Course texts provided!



Guest Speakers

- Adam Transue (NRES/Native Plants)
- Codie Sterner (ICAP)
- Daphne Hulse (Zero Waste)
- Morgan White (Energy Topics)



Hands-on Native Plant care Class

NRES 294

Presenter – Adam Transue, transue3@illinois.edu

Instructor – Pam Leiter, leiter@illinois.edu



01

Native plant class



NRES 294 – 1 credit hour

Academic Internship

Description:

- *Hands-on experience working with native plantings to demonstrate how native plants grow/interact and how pollinators benefit from these plantings. Field work will be focused on providing basic maintenance (weeding, thinning, replanting) to LAR plantings.*
- Meets in and around Lincoln Avenue Residence Hall.
- Sustainability LLC students given priority; other students may register if there's room in the class



02

Native plant class



NRES 294

- Each Fall: Focus on prairie wildflower species
 - 1st 8 weeks
- Each Spring: Focus on woodland wildflower species
 - 2nd 8 weeks
- Up to 10 students
- Each week: 2 hrs class + 1 hr working in gardens
 - Lecture topics: native plant ID, plant ecology, and pollinator ecology
 - Garden work involved using multiple tools across each unique garden



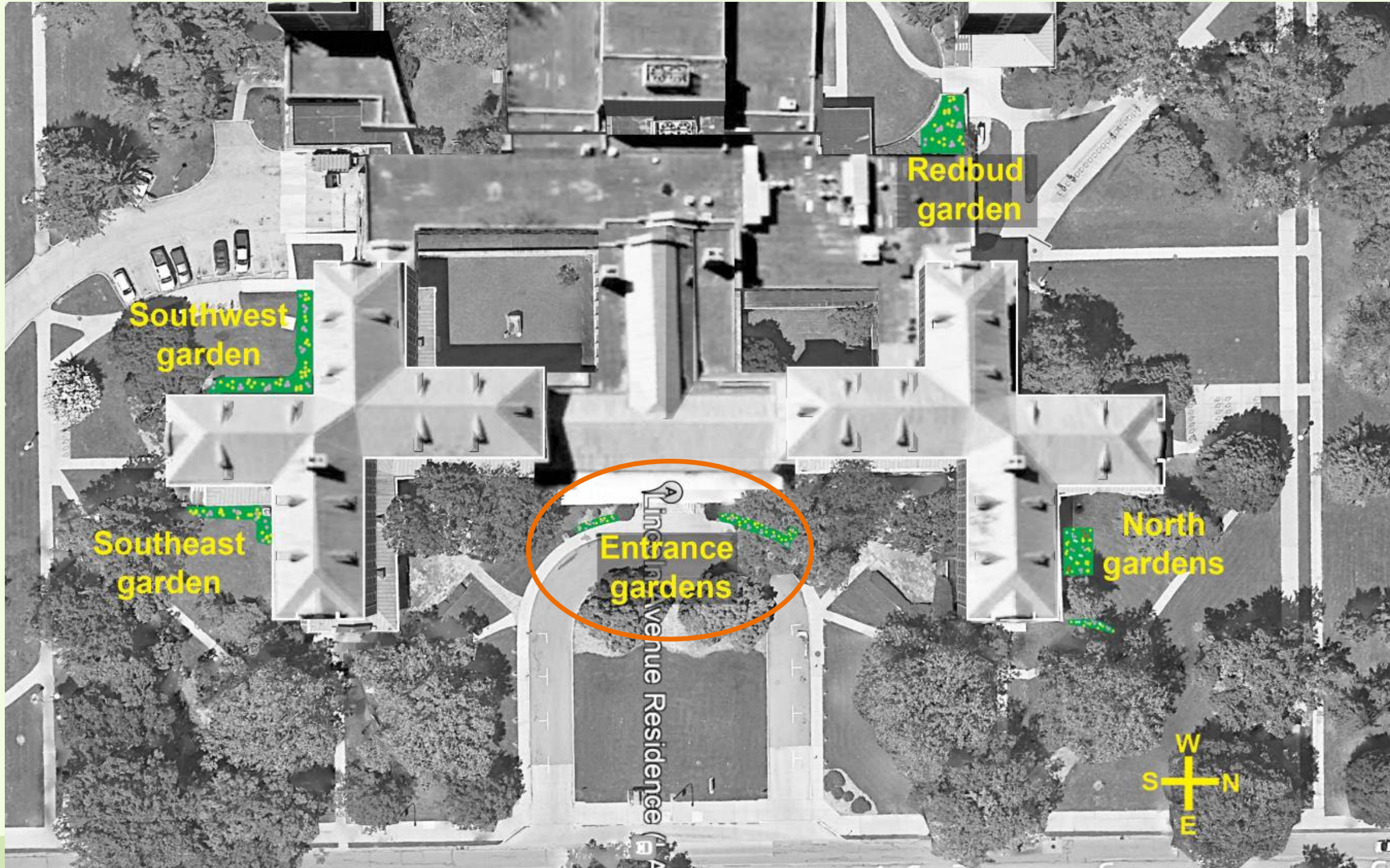

Redbud
garden

Southwest
garden

Southeast
garden

Entrance
gardens

North
gardens



Lincoln Avenue Residence



Future Vision

fall 2023 Planting

We planted 285 plants! 9 Species



Redbud
garden

Southwest
garden

Southeast
garden

Entrance
gardens

North
gardens

Lincoln Avenue Residence





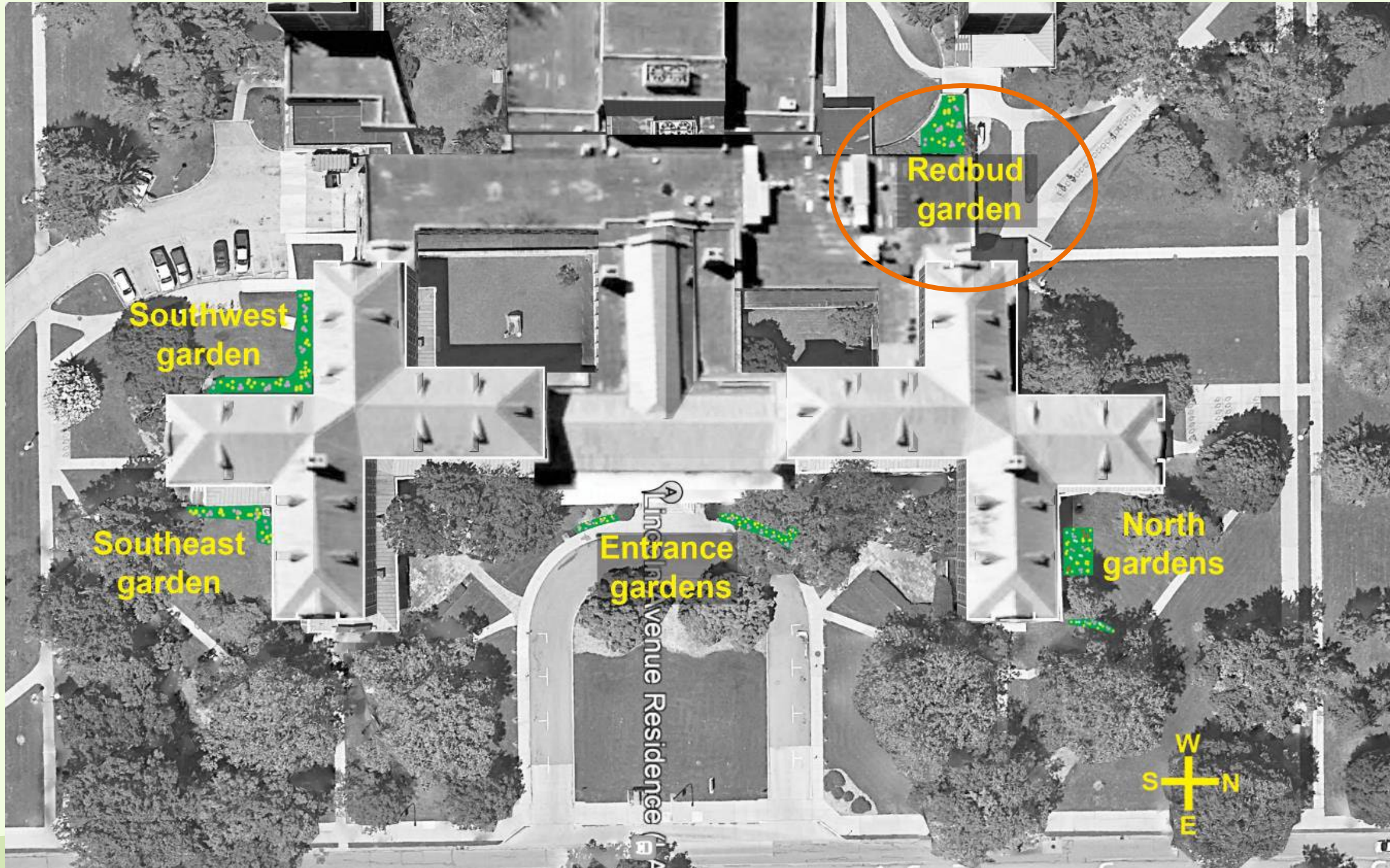

Redbud
garden

Southwest
garden

Southeast
garden

Entrance
gardens

North
gardens





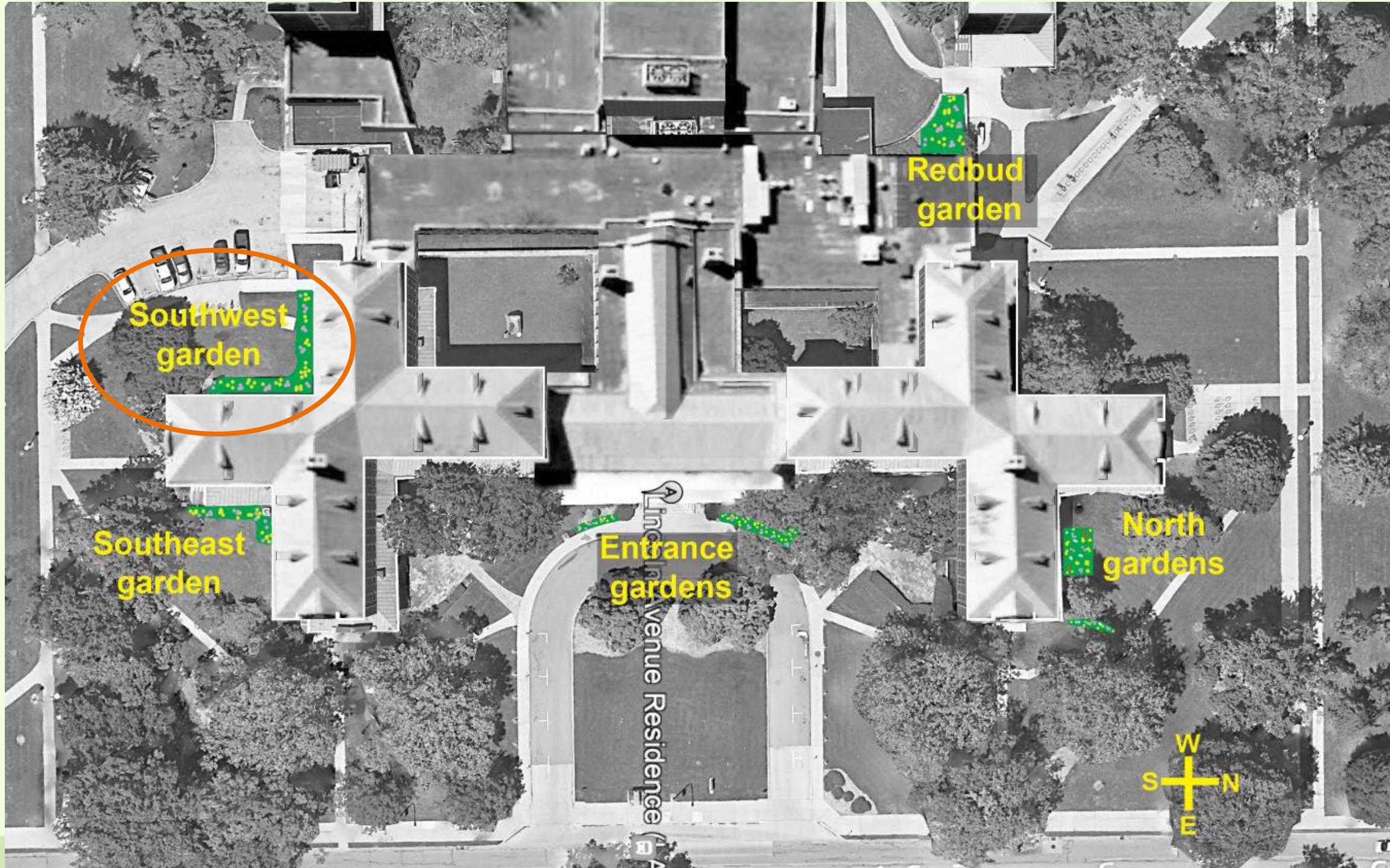

Redbud
garden

Southwest
garden

Southeast
garden

Lincoln Avenue Residence
Entrance
gardens

North
gardens





Redbud
garden

Southwest
garden

Southeast
garden

Entrance
gardens

North
gardens

Lincoln Avenue Residence







Thank you!

Hands-on Native Plant Care Class

NRES 294

Natural Resources & Environmental Sciences Dept

nres.illinois.edu

Pam Leiter

leiter@illinois.edu

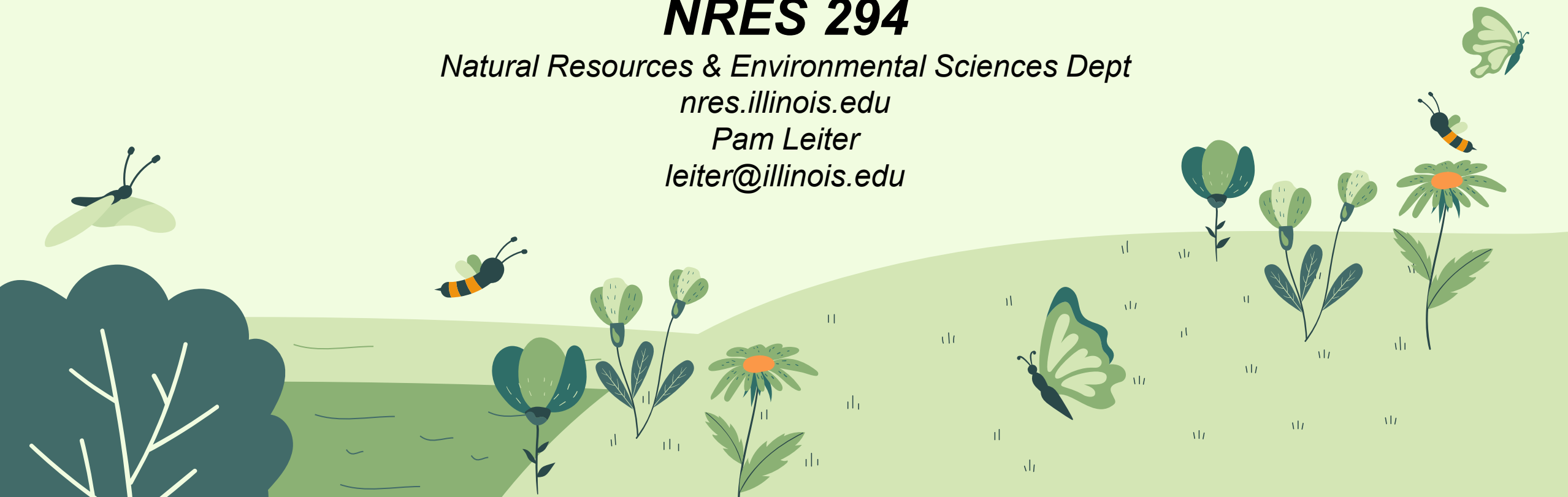

Sustainability Engagement

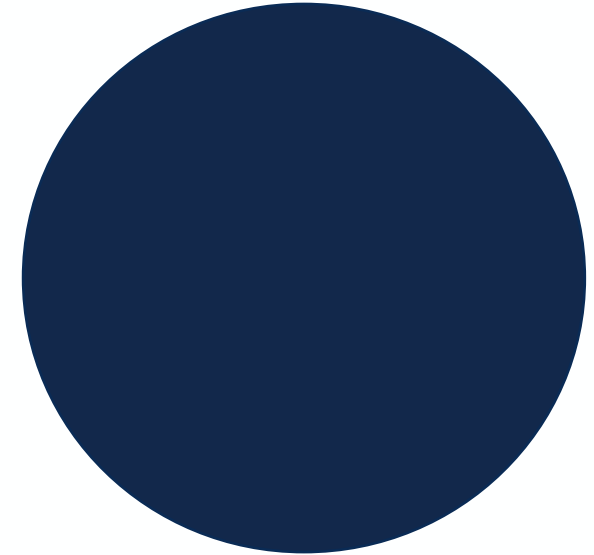

Codie Sterner, Sustainability Programs Manager

Student Success, Inclusion and Belonging | Student Affairs



Reimagine Our Future



go.illinois.edu/rof

A promotional banner for the 4th Annual Reimagine Our Future Undergraduate Sustainability Competition. The banner features a dark blue background on the left and an orange background on the right. On the left, there is a circular logo for the Illinois Green Fund Student Sustainability Committee. The text "4th ANNUAL" is in white on an orange bar. Below it, "Reimagine OUR FUTURE" is written in green, with a small globe icon for "OUR". Underneath, "Undergraduate Sustainability COMPETITION" is in white. A registration deadline "REGISTER BY 7 Oct. 2024" and submission deadline "SUBMISSIONS BY 20 Nov. 2024" are in white on an orange bar. Below that, the names of the organizers are listed: Prof. Leon Liebenberg (Engineering), Prof. Warren Lavey (Law), and Mr. Codie Sterner (SSC). On the right, a large profile of a human head is shown, filled with a satellite image of Earth. Overlaid on the head is the text "How will YOU reimagine our future?". The background of the right side is orange with a grid of sustainability-related terms in white, such as "SUSTAINABLE FARMING", "BUILDING DESIGN", "CLEAN ENERGY", "CAPTURE & REUSE", "LOGIC", "GREEN", "STRUCTURE DESIGN", "CLEAN WATER", "DROUGHT", "WASTE STREAM", "UPCYCLING", "EQUITY &", "LOCAL", "MITIGATION", "AQUACULTURE", "ASTAL POLLUT", "MITIGATION", "RESTORATION &", "HEALTHCARE", "ACCESS", "RESILIENT", and "CULTURAL PRACTICES". At the bottom right, the website "https://www.herox.com/reimagine2024" is listed next to a large blue "I" logo.



OneIllinois Student Affairs Sustainability



Join the **OneIllinois Student Affairs Sustainability Group** to

- Find opportunities to attend Green events, student groups, and get involved
- Stay up-to-date on current initiatives and ways you can be a sustainable student
- Connect with other environmentally passionate students
- Have a voice in Illinois' sustainability initiatives for years to come!

All Student Affairs
Sustainability

Info you need



Scan & Join



Green Guide



go.illinois.edu/greenguide

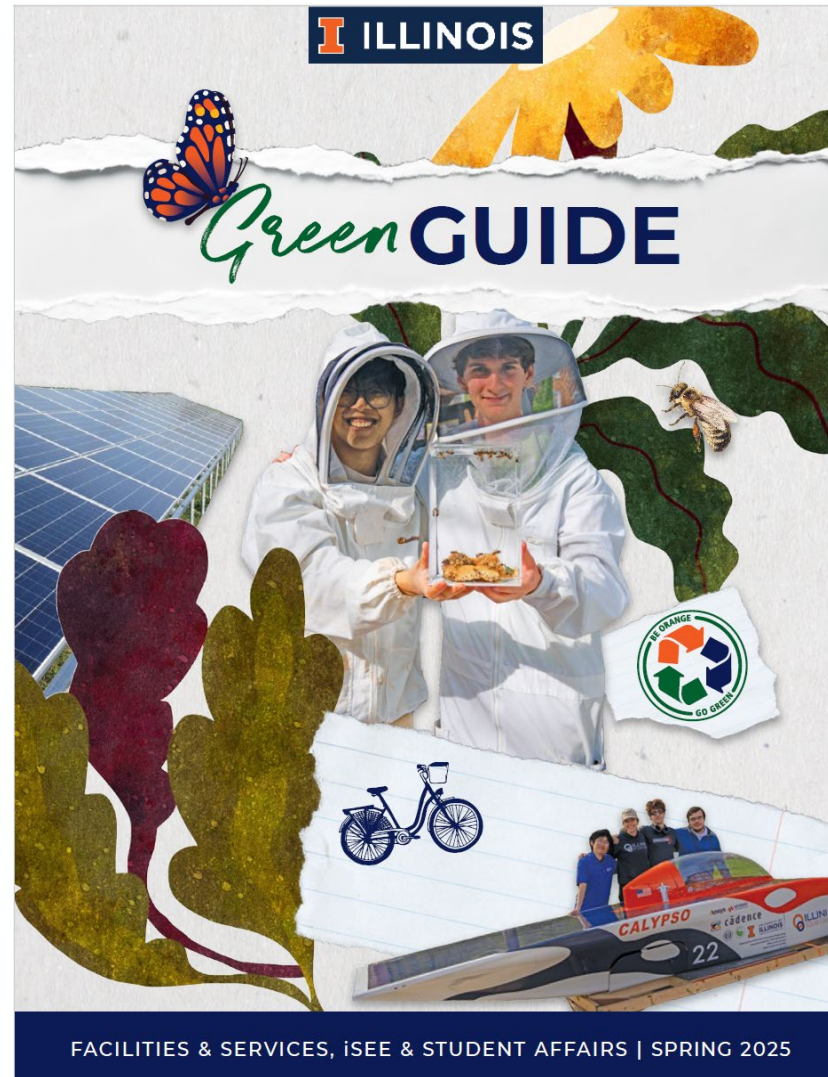

Zero Waste

Daphne Hulse, Zero Waste Coordinator
Facilities & Services

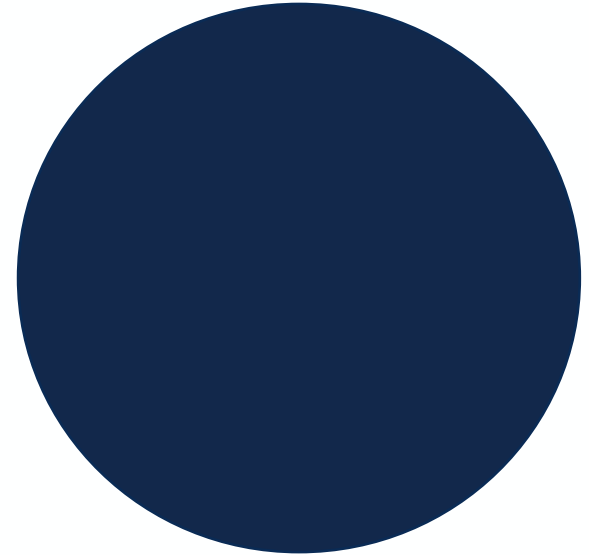

Recycling Education & Outreach

Explore more zero waste-related resources on the F&S website:



go.fs.illinois.edu/zerowaste

ILLINOIS RECYCLING GUIDE				
CARDBOARD	PAPER	ALUMINUM CANS	PLASTIC	LANDFILL
				
ACCEPTED <ul style="list-style-type: none">• Corrugated cardboard (staples & tape are allowed)• Pizza boxes must be predominantly free of any solid food residue and grease stains	ACCEPTED <ul style="list-style-type: none">• Office paper• Ream Wrappers• Colored paper• Notebook Paper• Mail & Envelopes• Books & Magazines• File Folders• Cardstock• Newspaper	ACCEPTED <ul style="list-style-type: none">• Aluminum Cans• Aluminum Cups	ACCEPTED <ul style="list-style-type: none">• Plastic #1 and #2: bottles, milk jugs, & laundry detergent containers	ACCEPTED <ul style="list-style-type: none">• Food, glass, foil, plastic #3 - #7, soiled cardboard, tissues, paper plates, Coffee Cups, etc.
NOT ACCEPTED <ul style="list-style-type: none">• Soiled, wet, or contaminated cardboard	NOT ACCEPTED <ul style="list-style-type: none">• Paper Towels• Napkins• Tissues• Paper Plates• Coffee Cups• Soiled Paper	NOT ACCEPTED <ul style="list-style-type: none">• Aluminum foil• Foil pans and trays	NOT ACCEPTED <ul style="list-style-type: none">• Glass• Plastic #3 - #7: styrofoam, containers, clamshells, single-use utensils, grocery bags, food wrappers, chip bags	

**Facilities & Services**

Questions? Email us at recycling@illinois.edu
fs.illinois.edu/recyclopedia





Reducing the Waste Stream Entirely

“The conservation of all resources by means of responsible production, consumption, reuse, and recovery of products, packaging, and materials without burning and with no discharges to land, water, or air that threaten the environment or human health.”

Zero Waste International Alliance

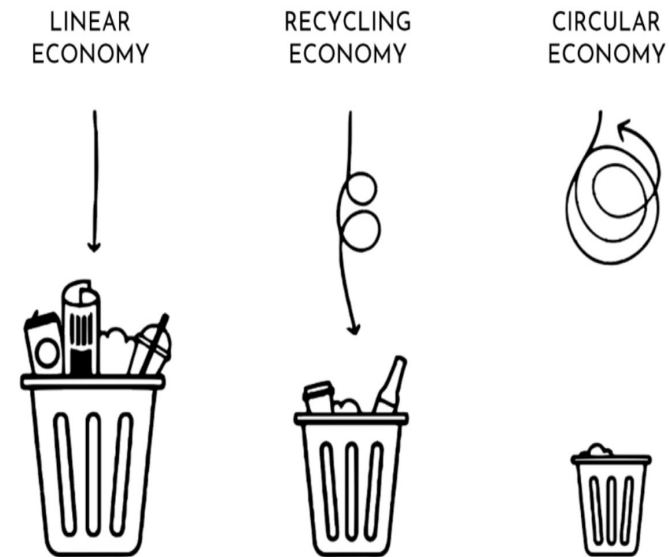

Upcoming Program: Dump & Run

- Builds donation habits
- Reduces landfilled waste (20,000 lbs. diverted every May)
- Strengthens relationships with community non-profit partners



Moving Out?
8 a.m. to 8 p.m., May 12-18
Find your nearest collection bin at dorms across campus.

Donate gently used items such as:

- Books
- Clothing
- Electronics
- Furniture
- Appliances
- and more!

→ [GO.FS.ILLINOIS.EDU/DUMPANDRUN](https://go.fs.illinois.edu/dumpandrunk)

Scan me!



Upcoming Program: Dump & Run



Energy Basics

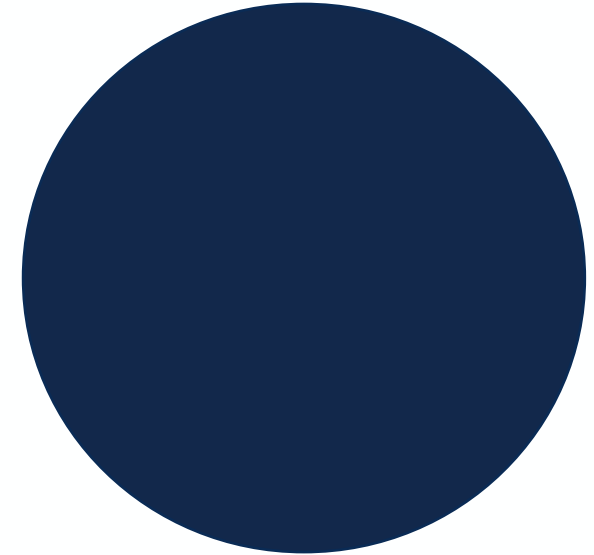

Morgan White, Associate Director

Facilities & Services



Energy Basics to Understand

What's a megawatt-hour?



- 60 watt lightbulb
- Leave it on for one hour
→ use 60 watt-hours
- Turn 1000 of these on for an hour
→ use 60,000 watt-hours
= 60 kilowatt-hours
- Do that 1000 times
→ use 60,000 kilowatt-hours
= 60 megawatt-hours
= 60 MWh

Energy Basics to Understand

How do we use Energy on campus?

- To keep buildings running
 - Lights, electronics, heating, cooling, equipment
- For electric vehicles
 - Owned by the university
 - Paid by personal owners at parking spaces
- For outdoor items
 - Street and pedestrian lights, lighting at night-time events, emergency phones, security cameras

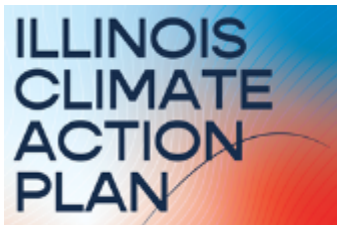

**Institute for Sustainability,
Energy, and Environment**
UNIVERSITY OF ILLINOIS URBANA-CHAMPAIGN



Facilities & Services
UNIVERSITY OF ILLINOIS URBANA-CHAMPAIGN

Energy Basics to Understand

How much Energy do we use?

- Daily? Monthly? Annually?
 - For the iCAP we focus on the annual numbers.
- We use the equivalent of about 1,300,000 megawatt-hours/year for electricity (power) and for thermal heating and cooling (steam and chilled water)
- We use about 360,000 MWh/year for electricity

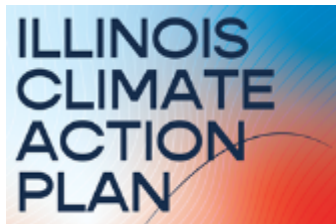

**Institute for Sustainability,
Energy, and Environment**
UNIVERSITY OF ILLINOIS URBANA-CHAMPAIGN



Facilities & Services
UNIVERSITY OF ILLINOIS URBANA-CHAMPAIGN

Energy Basics to Understand Where does our Energy come from?

13% of our annual power consumption is from clean energy!

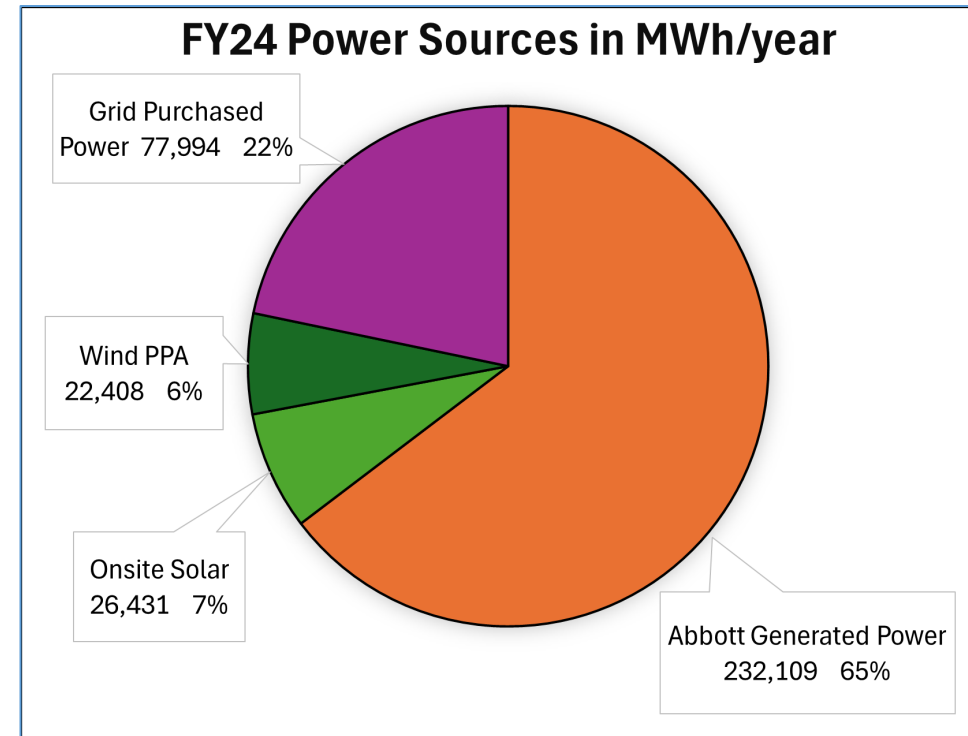
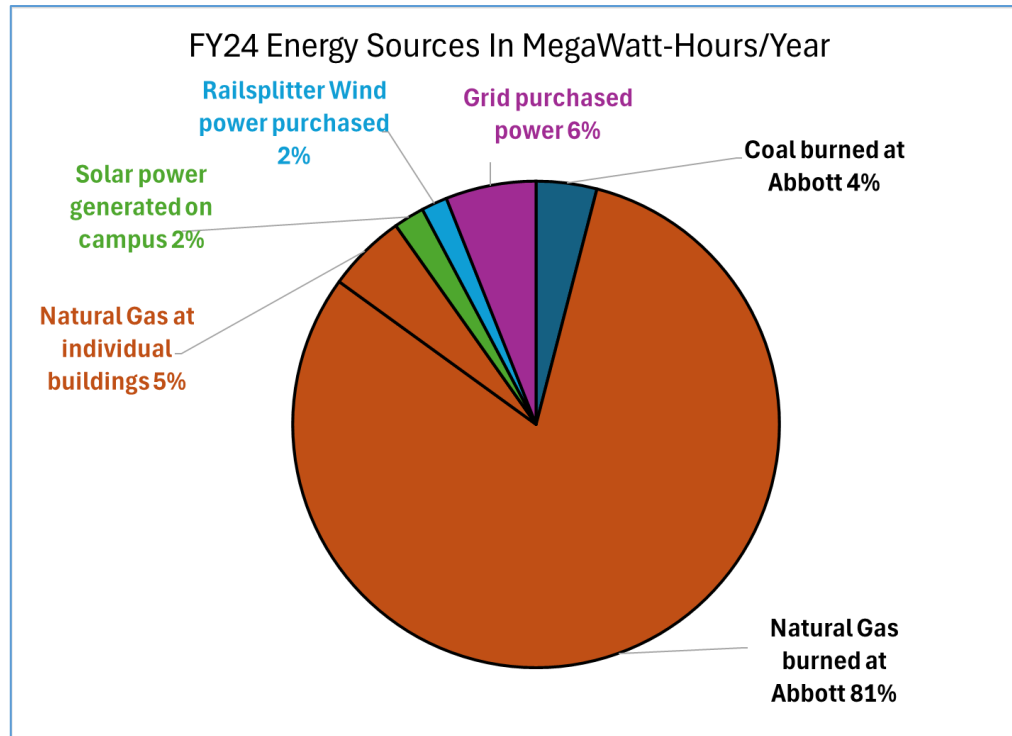

Please remember

Turn off that light bulb – it really helps!



- 60 watt lightbulb
- Turn it off for one hour
→ cut 60 watt-hours
- Turn 1,000,000 off for an hour
→ cut 60 MWh

- F&S will continue to work on energy conservation, energy efficiency, and clean energy projects for the campus.
- Your support matters a lot!!
- Let's keep winning this effort!

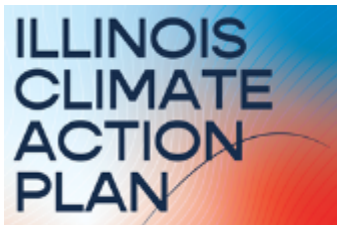

**Institute for Sustainability,
Energy, and Environment**
UNIVERSITY OF ILLINOIS URBANA-CHAMPAIGN



Facilities & Services
UNIVERSITY OF ILLINOIS URBANA-CHAMPAIGN

THANK YOU!

**ENJOY THE
FILMS!**

SSF 2025



Student Affairs

University Housing