

Campus Transportation Advisory Committee (CTAC)

University of Illinois Urbana-Champaign

Facilities & Services, April 15, 2024

Chair – Mohamed Sultan

Director of Capital Programs



Facilities & Services

UNIVERSITY OF ILLINOIS URBANA-CHAMPAIGN

Welcome!



Facilities & Services

UNIVERSITY OF ILLINOIS URBANA-CHAMPAIGN

Agenda

- Introduction – Mohamed Sultan (5 minutes)
- Old Business
 - F&S TDM Status Update – Stacey DeLorenzo and Sarthak Prasad (20 minutes)
 - ADA Transition Plan project updates – Sarthak Prasad (10 minutes)
 - 2024 Campus Bicycle Plan: Goals and Objectives and Infrastructure projects – Sarthak Prasad (45 minutes)
 - Bike Share Updates– Sarthak Prasad (5 minutes)
- Community Updates – (5 minutes)



Agenda

- Introduction – Mohamed Sultan (5 minutes)
- Old Business
 - F&S TDM Status Update – Stacey DeLorenzo and Sarthak Prasad (20 minutes)
 - ADA Transition Plan project updates – Sarthak Prasad (10 minutes)
 - 2024 Campus Bicycle Plan: Goals and Objectives and Infrastructure projects – Sarthak Prasad (45 minutes)
 - Bike Share Updates– Sarthak Prasad (5 minutes)
- Community Updates – (5 minutes)



Introduction - Members

Mohamed Sultan, chair

Staff

Lt. James Carter
Det. Tara Hurless
Yasmin Ofiana
Zach Acton
Erin Kristovich
Cheryl Bicknell
Brent Lewis
Pete Varney
Jake Benjamin
Matt Brown
Laura Bleill
Dana Decair
Jamie Singson

Codie Sterner
Jennifer Fraterrigo
Miriam Keep
Mylinda Netherton
Nizam Arain
Kathy Walsh

Faculty

Ray Benekohal
Bumsoo Lee
Lindsey Braun
Bill Sullivan
Shelly Zhang
Yanfeng Ouyang

Community representatives

David Happ, Champaign
John Zeman, Urbana
Jay Rank, MTD
Roland White, Savoy
Rita Morocoima-Black, CCRPC

Students

Transportation iCAP Team
Sam Wuebbles
Tushar Kokitkar
Ethan Garcia
Quinn Connolly

Stacey DeLorenzo, ex-officio

Sarthak Prasad, ex-officio



CTAC Responsibilities

- Review aspects of surface transportation on campus, including
 - Pedestrian, bicycle, transit and motorized facilities infrastructure
 - Safety for all modes of transportation interaction on campus
- Responsibilities include items such as:
 - Help identify needs and share information about pedestrian safety initiatives and priorities.
 - Review and make recommendations for prioritizing bicycle infrastructure, education, and enforcement on campus.
 - Provide advisory input to the Commuter Program.
 - Review and comment on matters relating to student, faculty, and staff transportation, when needed.



Agenda

- Introduction – Mohamed Sultan (5 minutes)
- Old Business
 - **F&S TDM Status Update – Stacey DeLorenzo and Sarthak Prasad (20 minutes)**
 - ADA Transition Plan project updates – Sarthak Prasad (10 minutes)
 - 2024 Campus Bicycle Plan: Goals and Objectives and Infrastructure projects – Sarthak Prasad (45 minutes)
 - Bike Share Updates– Sarthak Prasad (5 minutes)
- Community Updates – (5 minutes)



F&S TDM Status Update: Progress reports



Facilities & Services

UNIVERSITY OF ILLINOIS URBANA-CHAMPAIGN

Progress Reports FY24

- **Campus Bike Plan progress report**
 - Published in spring 2024
 - [Campus Bike Plan progress report FY23](#)
- **TDM Plan Annual Report**
 - Will be published in spring 2024



Highlights from Campus Bike Plan report

- Bicycle Programs & Infrastructure Fee (Bike Fee) was approved for FY25
- Renewed the Silver level Bicycle Friendly University (BFU) status
- Three bicycle repair stations maintained by F&S TDM were replaced and five additional bicycle repair stations and pumps were installed on campus at the following locations:
 - Main Library
 - West of Smith Hall
 - ECE/Micro Nano
 - Loomis Lab
 - Grainger Library
- Project to improve the curb cut at the intersection of Main St and Mathews Ave was completed.
 - SSC funded project
- Held “Bike to Work Day 2023” with 1,075 pre-registered participants, 100 on-site registrations, and 1,100 t-shirts handed out.
- Held “Light the Night 2023” event where 850 bike light sets were installed
- Updated Veo contract to allow 750 bicycles on campus. Contract was updated for 5-years in FY23.
- Purchased 14 Eco-Counters for 7 locations. Locations have been approved by the Architecture Review Committee.

10



Highlights from TDM Plan Achievement report

- **Asset Management Plan**

- Asphalt patching & Mill/Overlay –\$1,660,000 – awarded & will be started after commencement
- *PCC patches: \$615,000 – PUT ON HOLD DUE TO NEW FACILITIES CONSTRUCTION TRAFFIC ALONG LINCOLN*
- Preliminary design costs for future capital projects: \$375,000 – design complete & in review
 - Dorner Dr from Gregory Dr to Pennsylvania Ave
 - Pennsylvania Ave (in Urbana) from city limit to Lincoln Ave
 - St. Mary's Rd from First St to Fourth St
- Corridor study for safety improvement along Lincoln Ave from Florida to Windsor: \$150,000 – design to be completed by May
- The Street Jurisdiction map was updated in spring 2024 for F&S Paint Shop to stripe and paint the university-owned streets and crosswalks
- Design and Bid completed to reconstruct
 - North sidewalk on Peabody Drive from First Street to Fourth Street; North sidewalk on Gregory Drive from Fourth Street to Sixth Street
 - Complete street & crosswalk addition along Oak St south of Kirby
- Purchased 14 new counters to install at seven campus locations
- Renewed the Silver level Bicycle Friendly University (BFU) status

- **Programming**

- The [Bike at Illinois website](#) features information on bicycle education and facilities, bike sharing, registration, safety, and more. The [F&S website](#) includes information on walking, MTD buses, accessibility, and car-share options.

- **Collaborations**

- Collaborated with faculty, students, and staff on various projects

11



F&S TDM Status Update: Bike at Illinois



Bike Registration

- Number of Registrations:
 - FY21: 506
 - FY22: 685
 - FY23: 927
 - FY24 (so far): 854
- Monthly numbers can be found on the iCAP Portal:
<https://icap.sustainability.illinois.edu/project/bicycle-registration>
- Only about 54% of those registered have collected their shield stickers
- Bike Registration Signs: 16 locations (SSC funded)



Bicycle Repair Stations

- Total number of bicycle repair stations on campus = 17
- Number of bicycle repair stations at Housing facilities = 8
- Remaining nine repair stations are managed by F&S
- Existing the bicycle repair stations at
 - Campus Bike Center - replaced
 - Altgeld Hall - replaced
 - Parking lot C-5 (by International Studies Building) - replaced
 - Siebel Center for Design
 - Main Library
 - West of Smith Hall
 - ECE/Micro Nano
 - Loomis Lab
- Added new bicycle repair stations at:
 - Grainger Library
- Go to <https://bike.illinois.edu/maps/biking-map/>

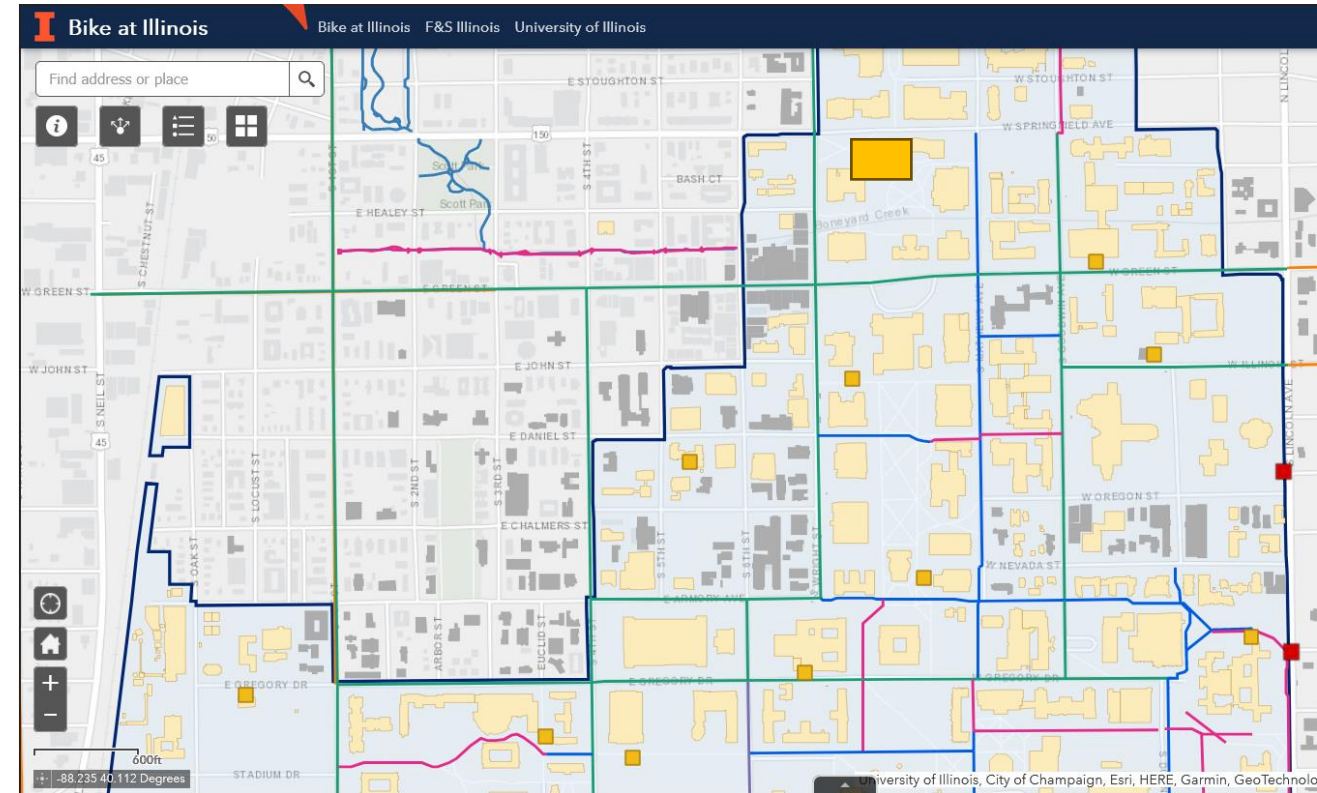

Existing bike repair stations

Campus Bike Center



SCD



Library and Information Science



Altgeld Hall

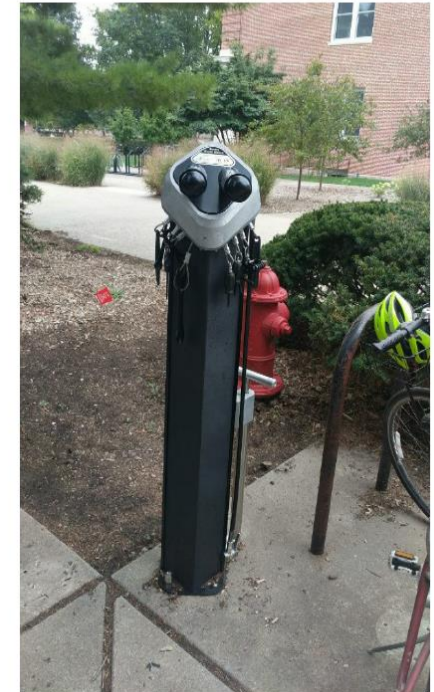

New bicycle repair stations

Loomis Laboratory



ECE



Main Library

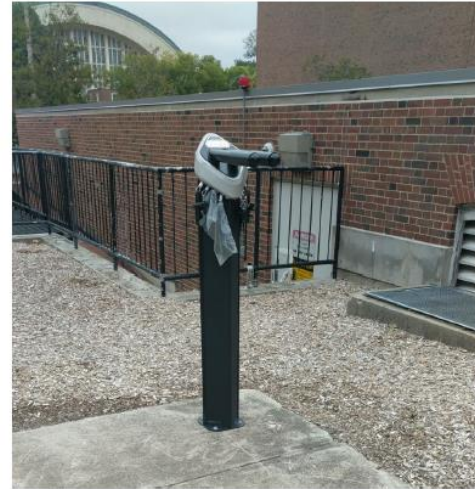

Follinger Auditorium

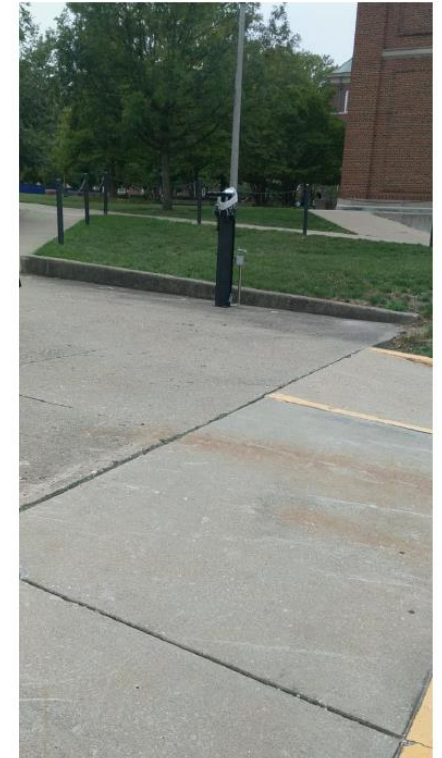

End of year round up of bicycles

- Hiring 1 or 2 students over the summer
- Messaging ready to be sent out to the campus about donating unwanted bicycles to the Bike Center or the Bike Project
- Project will begin after graduation
- Tag the abandoned bicycles: Last week of May to first week of June
- 2 weeks of notice to remove the tags
- Verification of abandoned bicycles: Mid to end of June
- Removal of abandoned bicycles and transportation of the abandoned bicycles (by Parking) to Round Barns: by end of June
- Inventory of all bicycles at Round Barns: by last week of July
- Retrieval of bicycles by users: Last week of August until September 20, 2024
- Donations of unclaimed bicycles to Working bikes and the Bike Project of Urbana-Champaign: October 2024

17



F&S TDM Status Update – SSC funded projects



SSC projects for FY24

- Curb cut improvement at the intersection of Main St and Mathews Ave – SSC awarded \$30,000
 - Completed
- EV charging stations for F&S fleet – SSC awarded \$134,000
 - Installed EV chargers for 5 locations, working on getting more
 - Will hire a student in Fall semester to analyze the data
- Shipping containers for bicycle storage – Requested SSC for \$85,000
 - Step-2 application submitted Spring 2024
 - Storage for students only
 - Seasonal storage – winter, summer, during the semester
 - Storage for abandoned bicycles over the summer
- Eco-Counters - \$120,000 funded in spring 2022
 - Purchased the counters
 - Working on installation – Expected summer 2024

19



Curb cut improvement at Main & Mathews

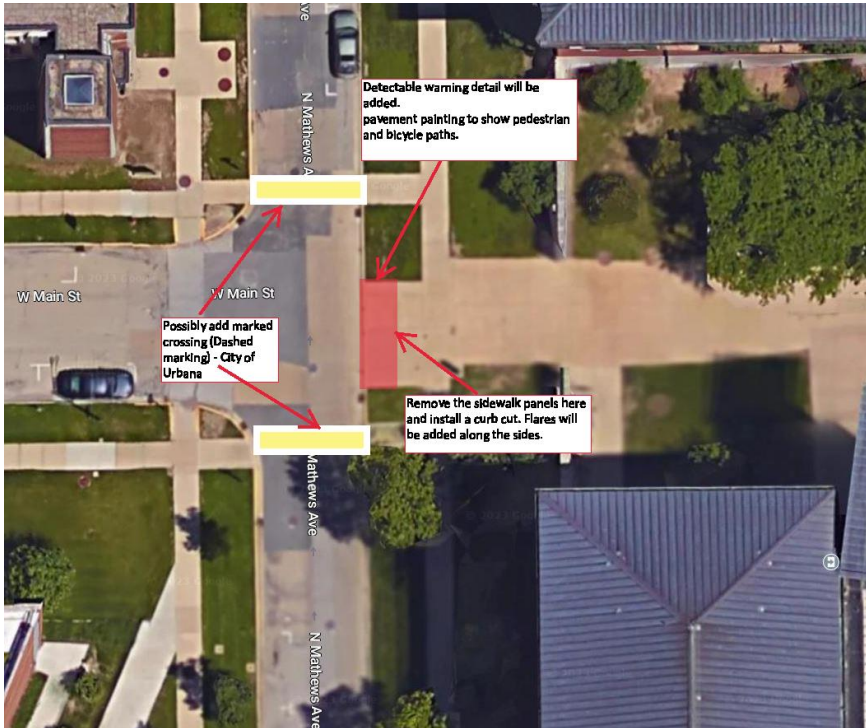



EV charging stations for F&S fleet

- F&S Fleet operations
 - 6 Ford F150 Lightning all electric trucks
 - 2 Ford e-transit
 - 5 EV charging stations installed
 - SSC funded
 - More EVs and EV chargers are on order
 - Responsible unit: F&S Transportation & Building Services
- Only available for F&S vehicles





Facilities & Services
UNIVERSITY OF ILLINOIS URBANA-CHAMPAIGN

Inspiration • Innovation • Leadership • Perseverance • Agility

Shipping containers for bike storage

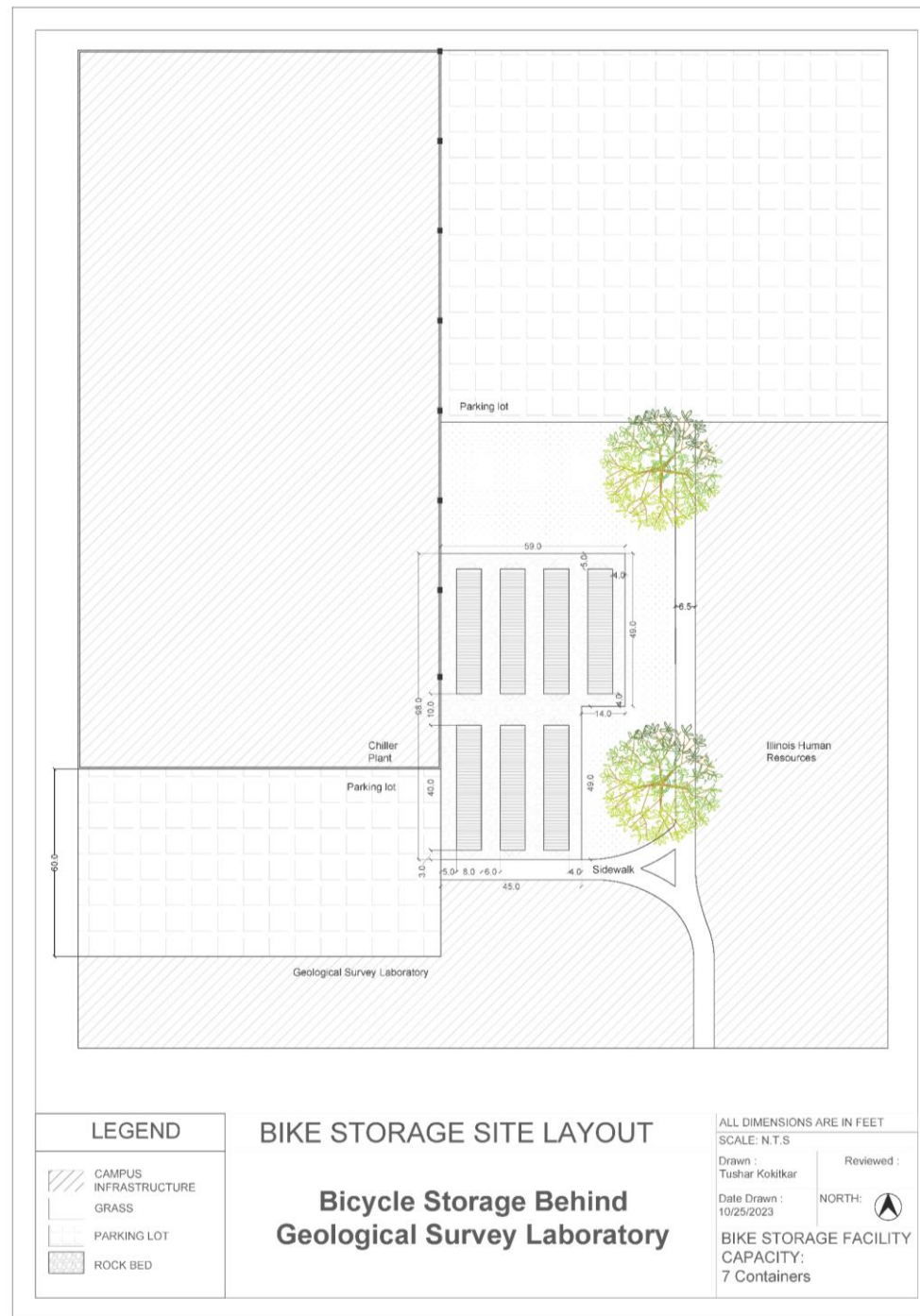
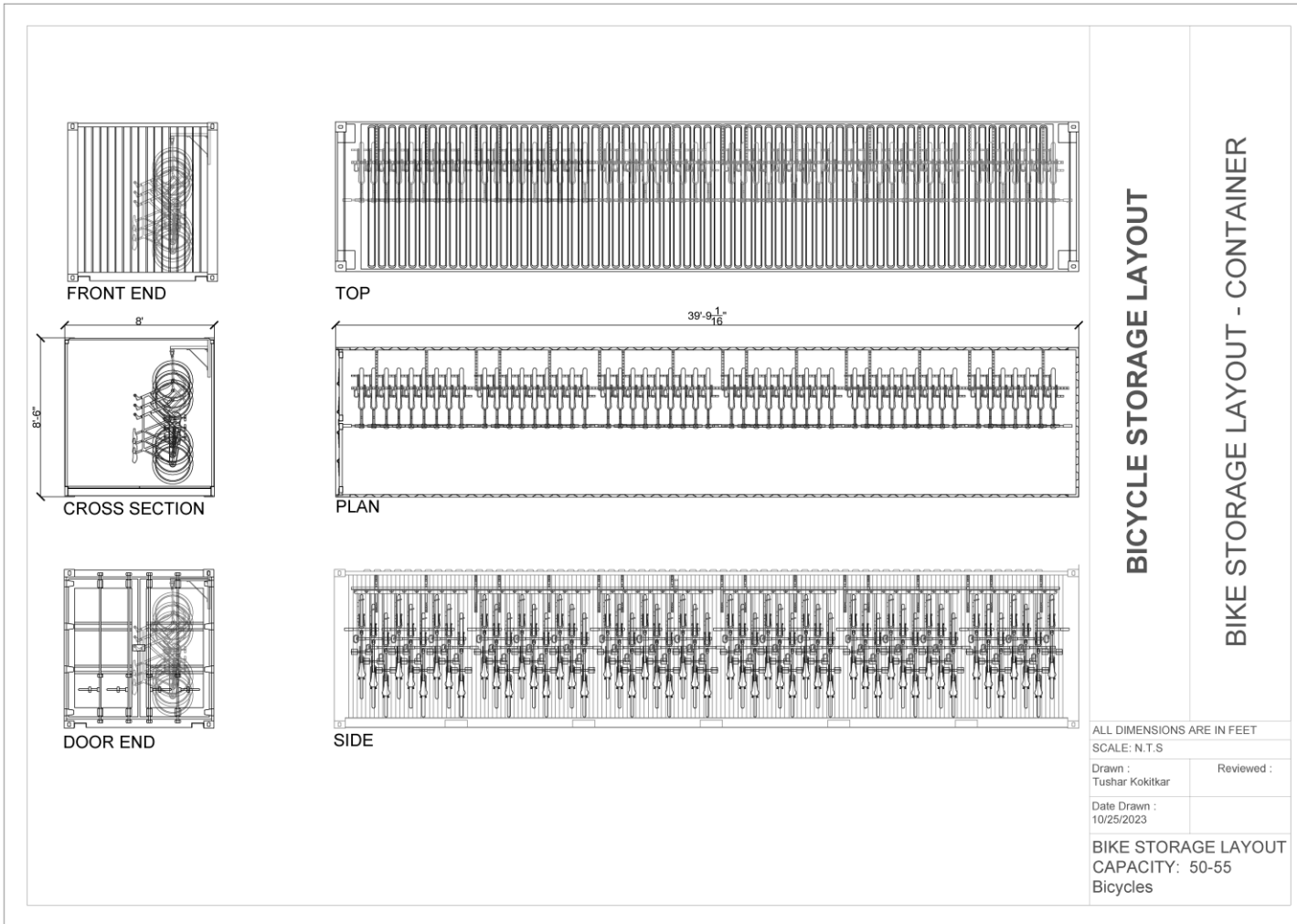















Eco-Counters

- Counters at John and Wright street installed in July 2023
 - SSC funded project
- Purchased 14 more counters for 7 more locations on campus locations – Locations approved by ARC
 - Intersection of Lincoln and Green
 - Intersection of Armory and Fourth
 - Savoy – First St shared use path
 - 4 counters around the Main Quad
 - First St close to Ikenberry Commons
 - Intersection of Goodwin and Gregory
 - IGB broadwalk by Morrow Plots
- Monthly data is posted on the iCAP Portal: [Pedestrian and Bicycle Counts](#)



New locations for the Eco-Counters

Open in My Maps

-  Main Quad NW corner
-  Noyes Lab/Natural History Building
-  Gregory Hall
-  Bevier Hall
-  First St Shared Use Path
-  East of Morrow Plots
-  First St - East side
-  First St - West Side
-  Armory & 4th - North side
-  Armory and 4th - South side
-  Goodwin and Gregory - West
-  Goodwin and Gregory - East
-  Green and Lincoln - North
-  Green and Lincoln - South

LESS

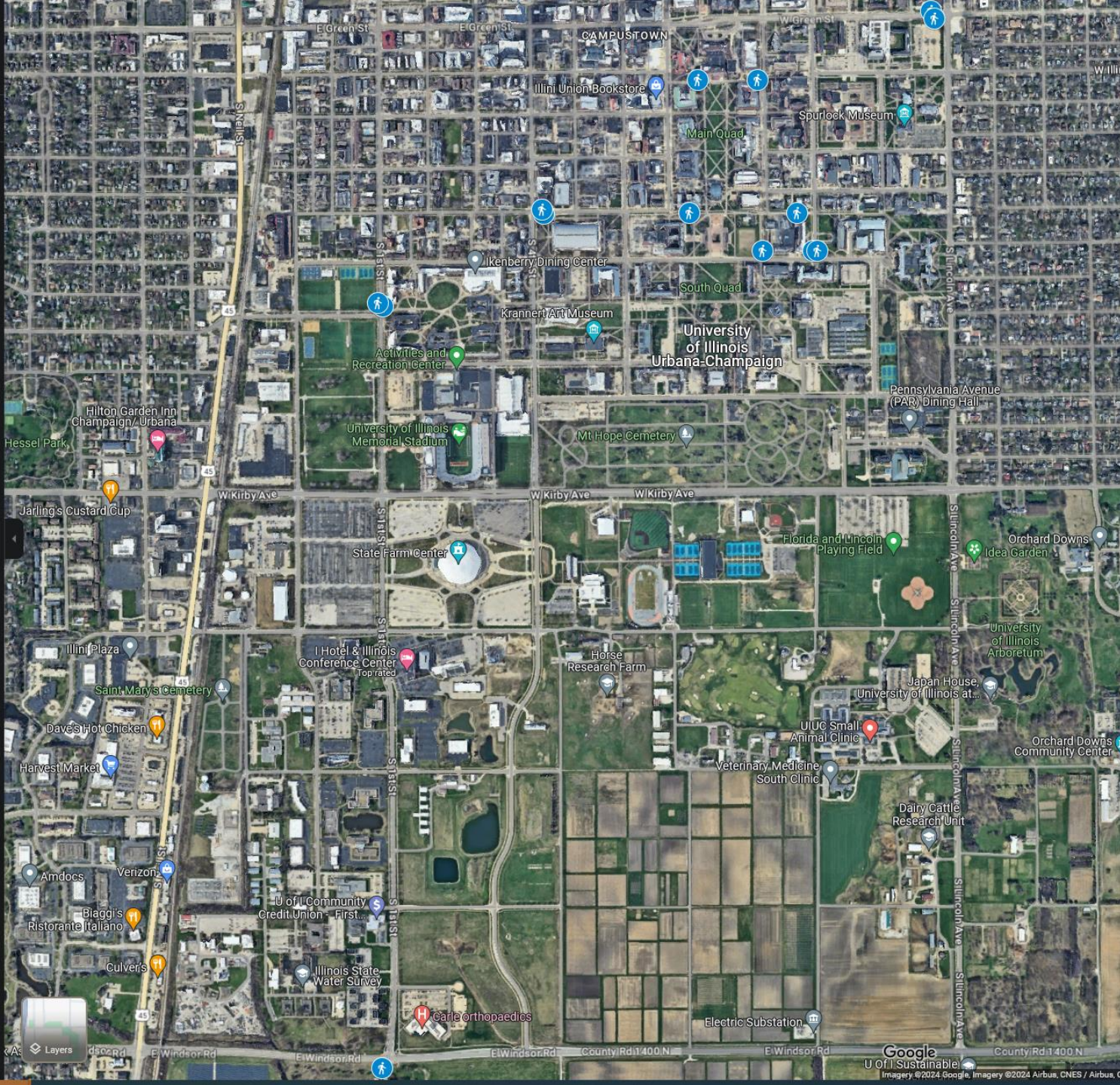

F&S TDM Status Update – Infrastructure updates



Infrastructure Project Updates (Encumbered in FY24)

- Asphalt patching & Mill/Overlay [construction to start May 2024] – \$1,660,000
 - Oak St from St. Mary's Rd to Gerty Dr
 - Gerty Dr from Griffith Dr to First St
 - Gregory Dr – east of First St
 - Gregory Dr from Fourth St to Dorner Dr
 - Goodwin Ave from Gregory Dr to Oregon St
 - Gregory St from Nevada St to Oregon St
 - Sixth St from Gregory Dr to Pennsylvania Ave
- Preliminary design costs for future capital projects [design completed April 2024]: \$375,000
- Dorner Dr from Gregory Dr to Pennsylvania Ave
- Pennsylvania Ave (in Urbana) from city limit to Lincoln Ave
- St. Mary's Rd from First St to Fourth St
- Corridor study for safety improvement along Lincoln Ave from Florida to Windsor [including round-about designed in previous project study]: \$150,000
- Oak St - Complete Street & Crosswalk Feasibility: \$25,000
- Oak St Complete Street & Sidewalk ; design kick-off April 2024: \$150,000



**F&S TDM Status Updates – Academic
Collaborations**



Academic Collaborations

- Bike Canopy – Ann Sychterz (CEE)
- Bio-oil as biobinder – Dr. Lance Schideman, Dr. Ramez Hajj, and Dr. Yuanhui Zhang
- Inspection and repair of campus pavements – Dr. Nishant Garg
 - SSC funded project
- CEE 190: Project Based Learning Class
- Circle Cycle – Illinois Enactus affiliated student-run RSO
- New Bike Shelter – Pranjali Shah (MUP-2), Mitchell Bryant, and Transportation iCAP Team
- Self-healing and Crack-sealing (Planning/Research)
 - Concrete – Dr. Nishant Garg
 - Asphalt – Dr. Ramez Hajj
- Bike Cage at ECE – Joyce Mast
 - SSC project (completed)
- Bike Theft and BFU application – Aparna Padmakumar (MUP-2)
- Strong Towns – Thomas Valencia and Briana Barr
 - SSC funded project
- Bike Canopy at Newmark – Ann Sychterz
- Bicycle Friendly University application – James “Alec” McKay
- 2024 Campus Bicycle Master Plan update – Ethan Garcia
- Bike Share with Veo contract update with Law students

30



Agenda

- Introduction – Mohamed Sultan (5 minutes)
- Old Business
 - F&S TDM Status Update – Stacey DeLorenzo and Sarthak Prasad (20 minutes)
 - **ADA Transition Plan project updates – Sarthak Prasad (10 minutes)**
 - 2024 Campus Bicycle Plan: Goals and Objectives and Infrastructure projects – Sarthak Prasad (45 minutes)
 - Bike Share Updates– Sarthak Prasad (5 minutes)
- Community Updates – (5 minutes)



ADA Transition Plan project updates



Completed projects

- North sidewalk along Stadium Drive between First Street and Oak Street – Completed in fall 2022 by Duce Construction – \$143,698.50
- West ADA entrance at the Armory Building – Completed in fall 2022 (In-house) - \$10,918.45
- West sidewalk along Oak Street – Completed in summer 2023 by Duce Construction – \$195,895
- New sidewalk on Hazelwood Dr from Oak St to ISTC - \$48,150
- Sidewalks around Armory Building – In-house - \$34,267
- East sidewalk along Fourth Street by Huff Hall - \$59,635
- Main Library - patch East side ADA ramp - Temp Fix - Construction Services - DAVIS & DAVIS - \$11,121
- English Building - \$49,713.85

33



Stadium Drive



West sidewalk on Oak Street

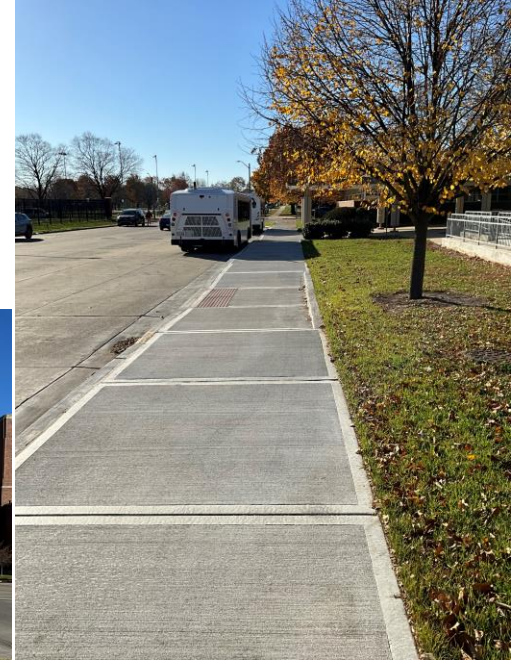

Hazelwood Dr – new sidewalk



36



Facilities & Services
UNIVERSITY OF ILLINOIS URBANA-CHAMPAIGN

Inspiration • Innovation • Leadership • Perseverance • Agility

New sidewalk on Hazelwood Dr from Oak St to ISTC



Fac
UNIVE

Inspiration • Innovation • Leadership • P

Huff Hall



Facilities & Services
UNIVERSITY OF ILLINOIS URBANA-CHAMPAIGN

Inspiration • Innovation • Leadership • Perseverance • Agility

Main Library - patch East side ADA ramp

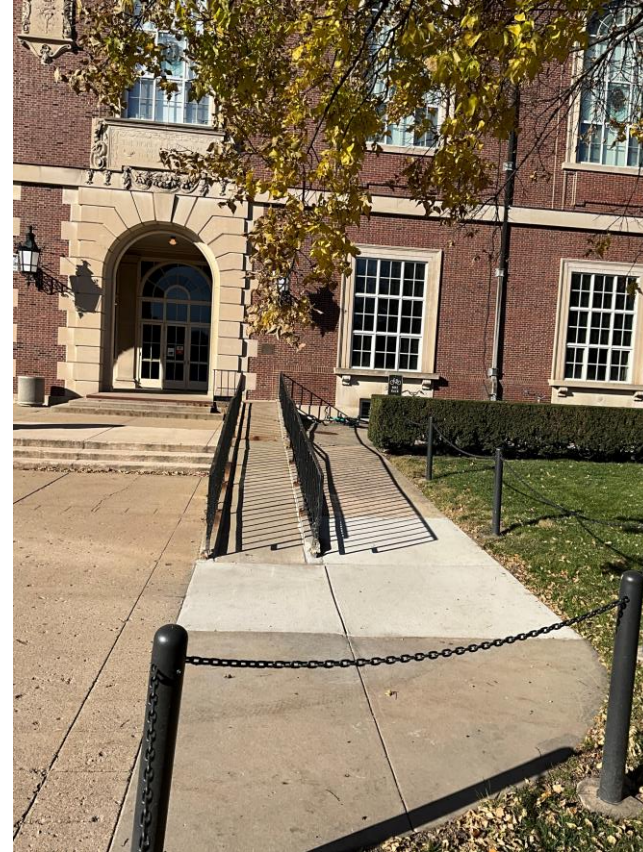

39



English Building – site

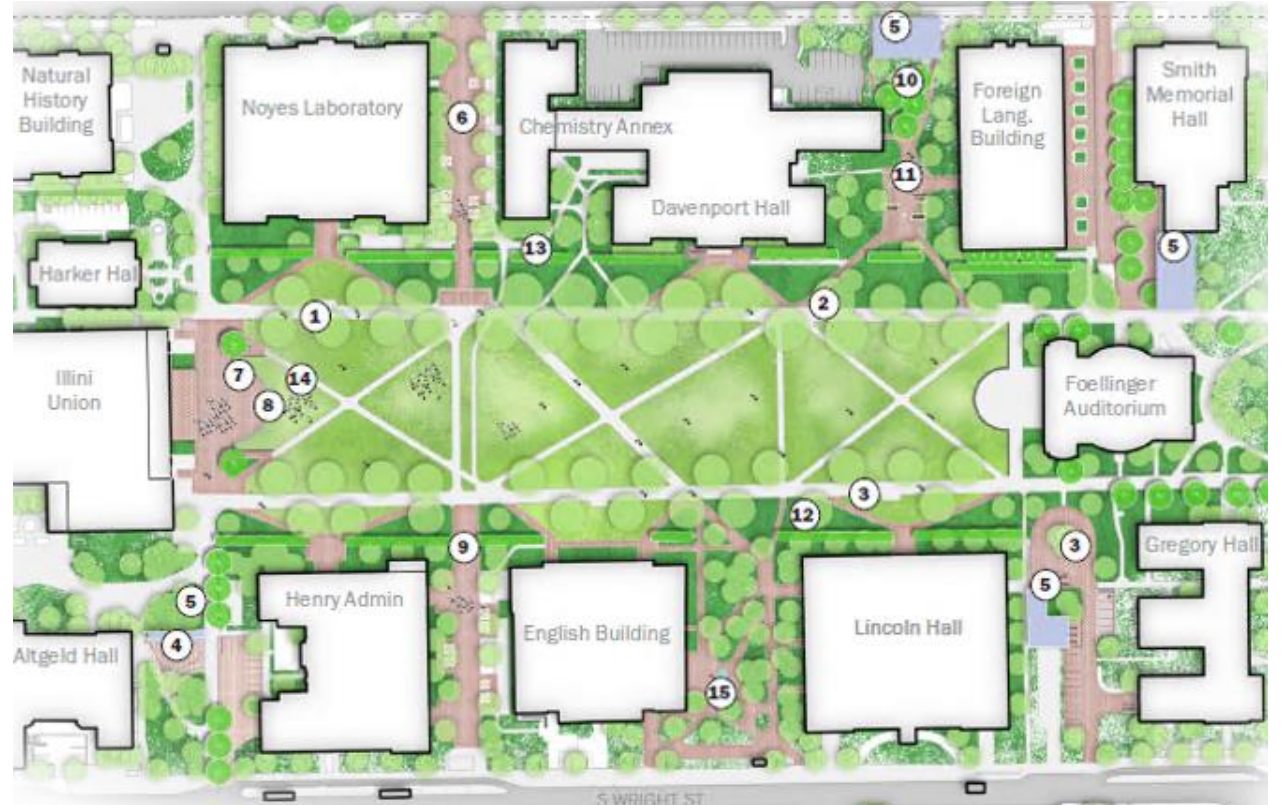
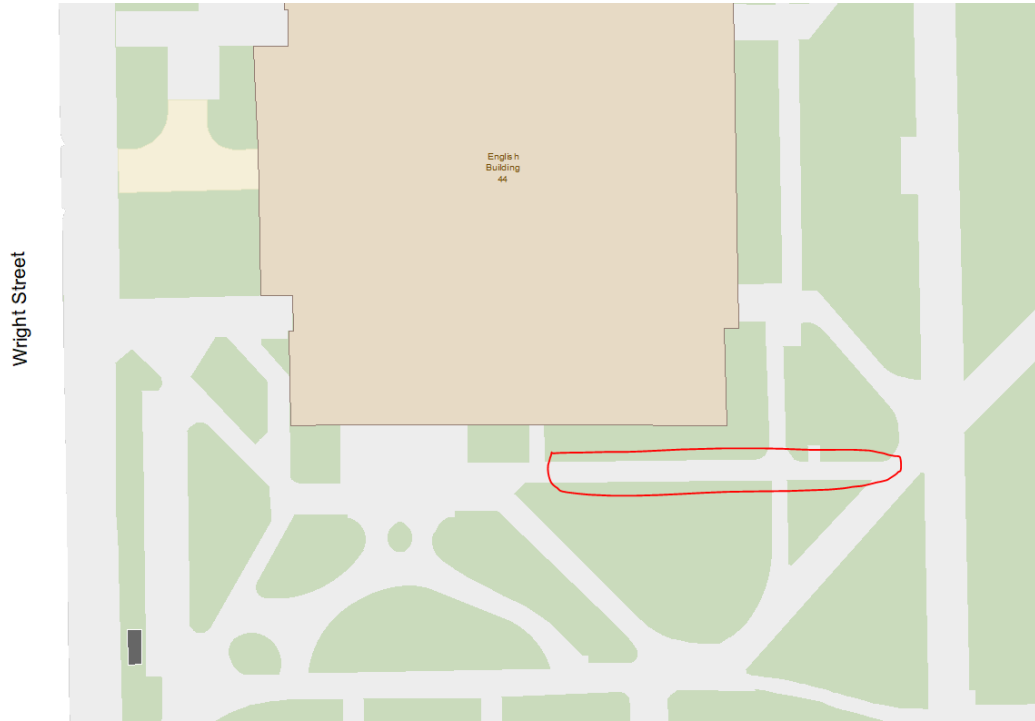

English Building

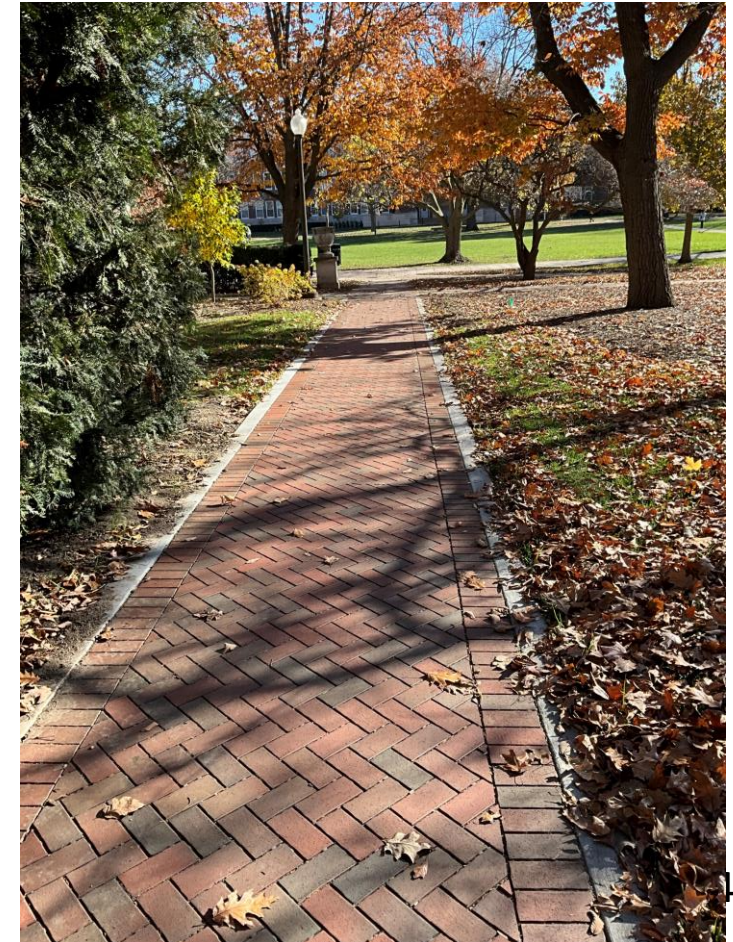

11



Facilities & Services
UNIVERSITY OF ILLINOIS URBANA-CHAMPAIGN

Inspiration • Innovation • Leadership • Perseverance • Agility

Design/Construction projects

- Following project with a combined budget of \$525,000; construction to start May 2024
 - North sidewalk on Peabody Drive from First Street to Fourth Street (and potentially to Sixth Street)
 - North sidewalk on Gregory Drive from Fourth Street to Sixth Street



Gregory Dr and Peabody Dr – sidewalk replacement

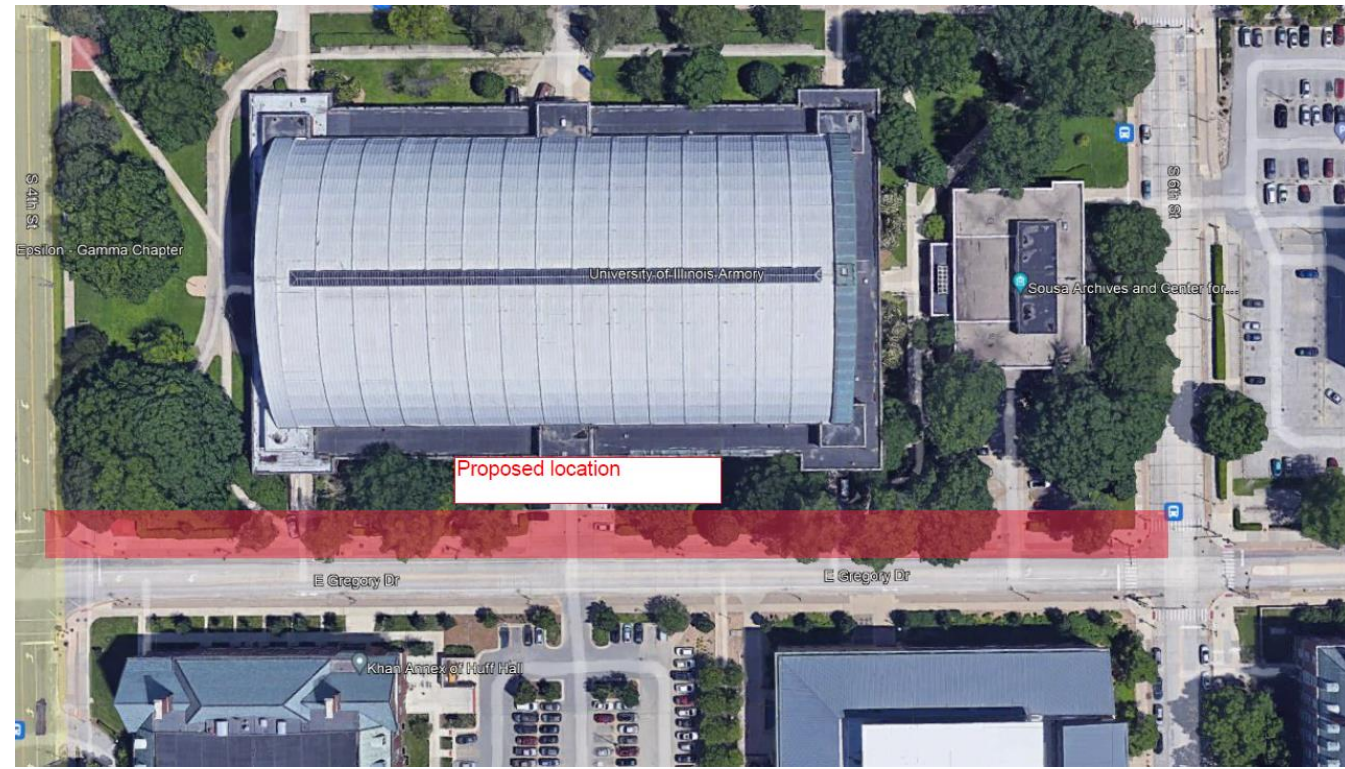
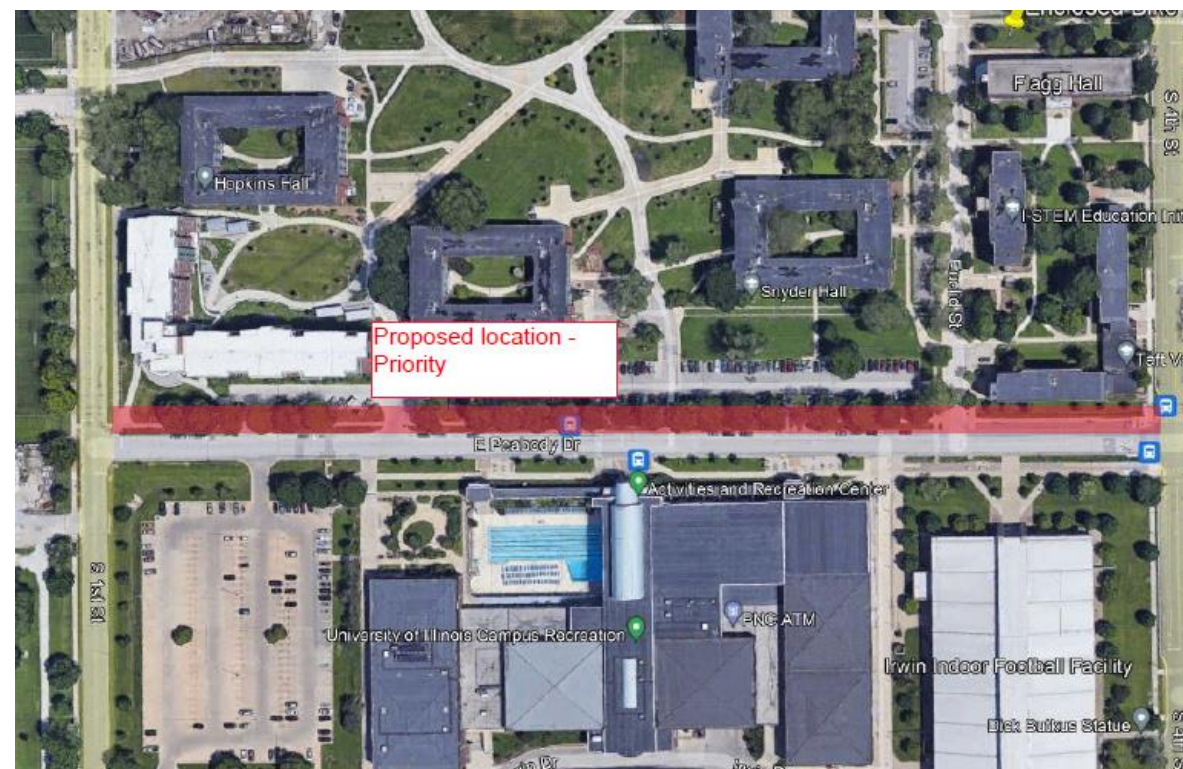

ADA compliance study

- ADA compliance study – DeepWalk - \$55,800
 - Contract issued with DeepWalk
 - Model the campus sidewalks and identify deficiencies on campus
 - Started collecting data in spring 2024
- Scope:
 - Sidewalks – 83.35 miles
- All data will be updated in our GIS database and shared

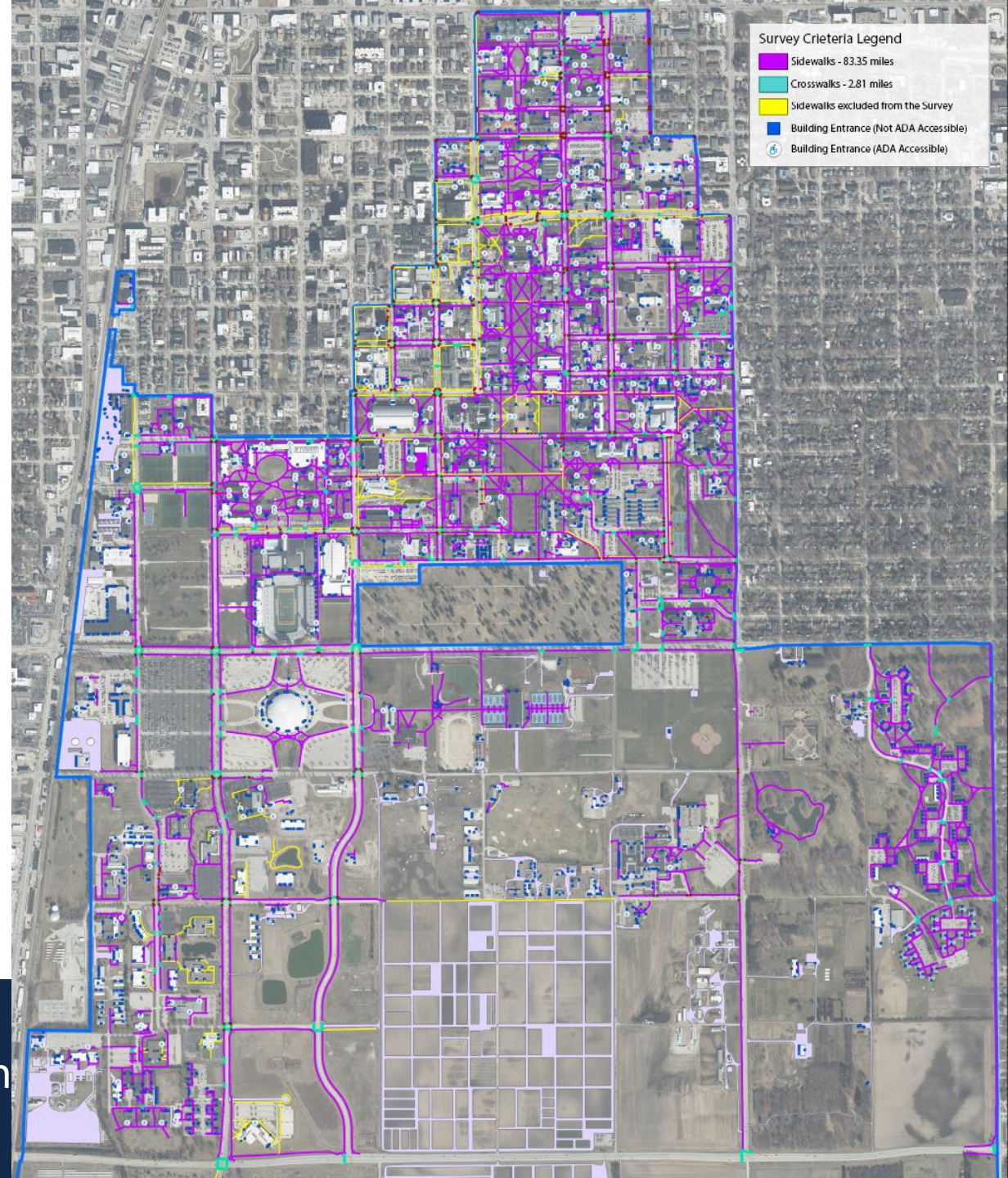

Agenda

- Introduction – Mohamed Sultan (5 minutes)
- Old Business
 - F&S TDM Status Update – Stacey DeLorenzo and Sarthak Prasad (20 minutes)
 - ADA Transition Plan project updates – Sarthak Prasad (10 minutes)
 - **2024 Campus Bicycle Plan: Goals and Objectives and Infrastructure projects – Sarthak Prasad (45 minutes)**
 - Bike Share Updates– Sarthak Prasad (5 minutes)
- Community Updates – (5 minutes)



2024 Campus Bicycle Plan: Goals and Objectives and Infrastructure projects



Goals and objectives are prioritized based on the following factors:

1. Safety for users is the highest priority: this includes all modes of transportation, including multi modal interactions.
2. Location: this refers to the impact on the overall networks and the perception of that impact.
3. Volume of Traffic: this reflects the number of users in the respective areas.
4. Condition: this considers the condition of the pavement and the scale of improvements needed in the respective area.
5. Alignment with campus plans: this considers the connections to strategic priorities and potential coordination with other campus projects.

47



Key Goals

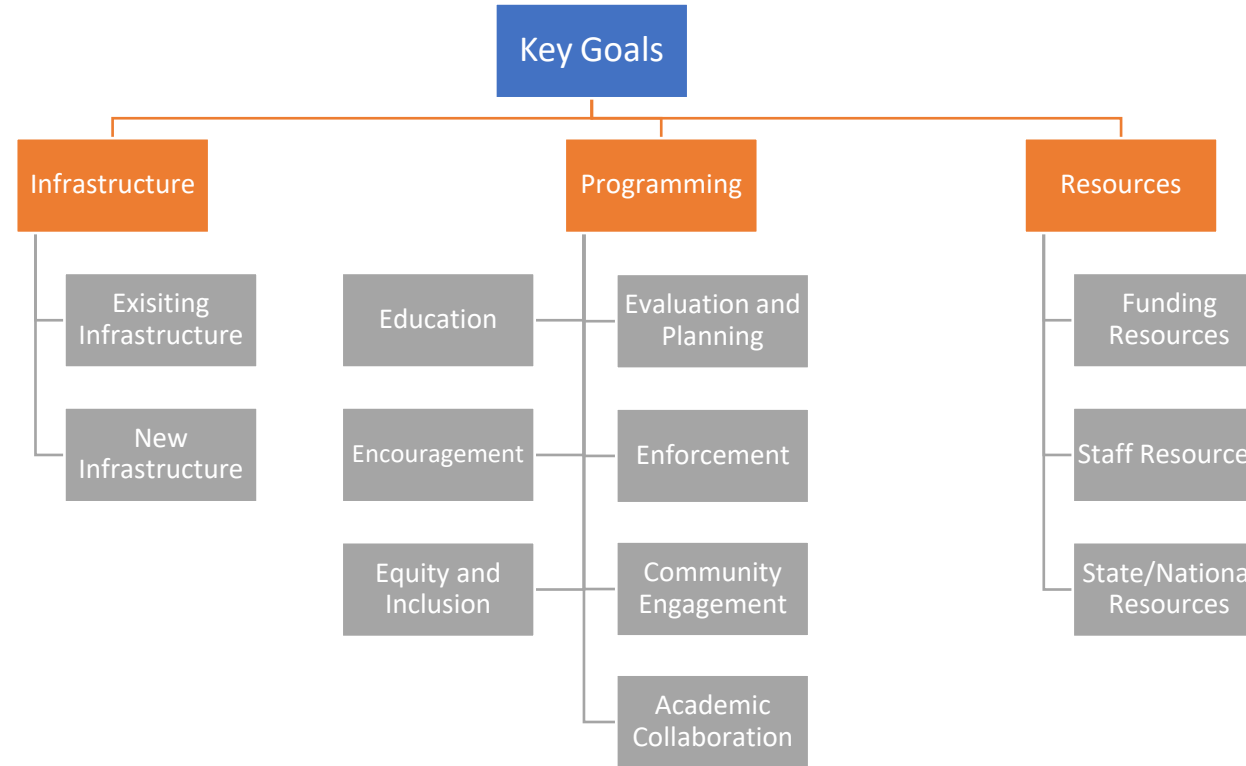

Key Goal: Infrastructure



Facilities & Services

UNIVERSITY OF ILLINOIS URBANA-CHAMPAIGN

Existing Infrastructure

1. Plan and implement a safe, contiguous network of bikeways throughout campus that adhere to campus facility standards and bikeway design guidelines included in Appendix A
 - a) 100% of the network installed and up to standard by June 30, 2035.
2. Conduct a thorough audit of the bicycle network and infrastructure by FY27
3. Encourage proper maintenance of bicycles by supporting the Campus Bike Center, mechanics courses, and campus bicycle repair stations.
4. Ensure 100% of short-term bicycle parking meets the APBP Guidelines by June 30, 2035.
5. Make 100% of the preferred bike routes accessible for wheelchair athletes' training by 2030.
6. Increase user friendliness of the campus bikeway network with improved signage and markings on all bikeway segments.
 - a) Bring 100% of bikeway facilities to have proper signage and markings by June 30, 2030.

50



New Infrastructure

1. Implement seasonal storage for students living in Housing facilities by 2025.
2. Provide a storage facility for the annual summer bicycle roundup by 2025.
3. Add 3 more bike shelters on campus by 2035 and additional 2 bike shelters by 2040 with location priority to high density/ traffic parking areas.
4. Install Bike Repair Stations around the Campus for convenient access to all students, faculty, and staff on campus.

51



Key Goal: Programming



Education

1. Develop more educational videos by 2026
 - a) Rules of the Road
 - b) Bicycle Safety
2. Video highlights for Bike to Work Day and Light the Night events annually starting 2024
3. Continue to provide information packets about bicycle safety to new students.
 - a) Include information on Bike Safety Quiz
4. Host or participate in bicycle-related engagement events on campus
5. Send the Bike at Illinois Newsletter at least once per semester. Information could include, not limited to,
 - a) Upcoming events
 - b) Reminder to collect shield stickers
 - c) Bike Safety Quiz
 - d) Properly locking bicycles
6. Promote the use of safe bike practices via digital signs like Rules of Road
7. Continue to tailor the safety and operational education program to incorporate micromobility devices



Encouragement

1. Continue to support the ongoing work at the Campus Bike Center.
2. Increase Campus Bike Center memberships by 5% per year.
3. Increase the number of visitors to the Campus Bike Center by 5% every year.
4. Increase incentives and services that encourage bicycle commuting.
5. Increase bicycle registration
 - a. Register at least 800 new bicycles per year starting FY24
 - b. Increase the shield sticker distribution to 75% by FY28
 - c. Increase the shield sticker distribution to 90% by FY32
 - d. Increase the shield sticker distribution to 100% by FY35
6. Implement a bicycle sharing program on campus for short-term or long-term use.
 - a. Support departmental bike share programs on campus
 - b. Offer long-term (monthly or semester-long) bicycle rentals through Campus Bike Center.
 - c. Increase the number of Bike Share Bicycles for public.
7. Develop a Bicycle Ambassadors program by FY27
8. Develop a Bike buddy program on campus by FY27
9. Have at least one League Certified Instructor (LCI) on campus at all time by FY25
10. Implement a Guaranteed Ride Home program on campus for users who do not purchase an annual parking permit by FY27



Equity and Inclusion

1. Improve connectivity within and beyond the University District by working with the Cities of Champaign and Urbana and the Village of Savoy to implement bicycle facilities that connect the campus with the greater community.
 - a) Continue collaborative planning efforts through CUUATS and other opportunities as they occur.
2. Establish a bikeway network that is convenient and accessible for a range of ridership skill levels, by providing an integrated mix of facility types.
 - a) Incorporate cargo, tandem, oversized, electric bike and other types of bikes in to the most popular bike parking locations by FY35.
3. Improve bicycles and street infrastructure for routes taken by wheelchair athletes and make them ADA compliant
https://icap.sustainability.illinois.edu/files/projectupdate/8909/Athelete%20Curcuit_U%20of%20I%20Campus%20Map.png



Evaluation and Planning

1. Reduce motor vehicle trips in the community and associated emissions by increasing mode shift toward bicycles.
 - a) Reduce single occupied vehicle usage to 45% by June 30, 2030.
2. Develop a Commuter Program to incentivize those who relinquish their parking permit by FY30
3. Increase the share of trips taken by bicycle
 - a) Increase the percentage of faculty and staff using bicycles as their primary mode of transportation on campus to 35% by FY35
 - b) Increase the percentage of students using bicycles as their primary mode of transportation on campus to 30% by FY35
4. Update the university facility standards based on technological advancement, to comply with industrial or universal standards, or as needed.
 - a) Form a task force to come up with a solution to manage E-bike charging and operations on campus by FY25
5. Improve the university's standing as a national leader in bicycle friendliness
 - a) Achieve Platinum-level Bicycle Friendly University status from the League of American Bicyclists.
 - i. Achieve Gold-level status by 2027
 - ii. Apply for and achieve Platinum-level status by 2035
 - b) Update the Campus Bicycle Plan once every ten years at a minimum to reflect best practices and existing opportunities.
 - i. Publish next updated Campus Bicycle Plan no later than 6/30/2034.
6. Support Champaign County's Vision Zero goal
7. Implement bicycle related projects from the Campus Landscape Master Plan 2022



Enforcement

1. Update and enforce the university's Bicycle Code, in addition to enforcing state and local traffic laws to ensure safe and legal behavior of cyclists.
 - a) Enforce impound fee by FY26
2. Install signage and enforce dismount zones on high pedestrian hotspots on-campus including locations such as Main Quad and Engineering Quad by FY30.
3. Continue to provide bicycle registration for the University, City of Champaign, City of Urbana, and Village of Savoy through a national bicycle registration system.



Community Engagement

1. Organize, promote, participate, and report on bicycle-related engagement events held on campus
2. Report the events in the community where the university participated or promoted
3. Continue to participate in the Bicycle & Pedestrian Advisory Commission of City of Urbana
4. Continue to work with RSOs and local groups such as Illini Cycling, Illini4000, Champaign County Bikes, Prairie Cycle Club, etc.



Academic Collaboration

1. Collaborate with students, faculty, and staff to improve bicycling on campus
2. Work with at least one student on bicycle related project every year



Key Goal: Resources



Facilities & Services

UNIVERSITY OF ILLINOIS URBANA-CHAMPAIGN

Funding Resources

1. Develop a plan and identify funding for the ongoing maintenance of the bikeway network.
 - a) Allocate funding to repaint all university owned in-road bicycle lanes and off-road bicycle paths each year.
 - b) Allocate funding to implement at least one bike network improvement project on campus each year
 - c) Appropriately fund the maintenance and improvement bicycle parking on campus every year
 - d) Allocate funding for the maintenance of Bike Repair Stations
2. Define specific budgets for the projects described in this plan
 - a) Select the appropriate funding and project requests each year, starting with FY25.
 - b) Request funding for at least two bikeway project phases per year.
3. Secure funding for ongoing bicycle improvements and programming.
 - a) Continue to include related bicycle infrastructure needs in project scope and budget for all Capital Construction Projects.
 - b) Allocate funding to increase covered and/or secured bicycle parking capacity on-campus every year.
4. Request SSC to fund at least one project directly related to this plan every year.
5. Identify an ongoing source of funding for continued maintenance and upkeep of the bikeway network and other bicycle infrastructure and programs.
 - a) Investigate funding options, including fees and donor support.



Staff Resources

1. Appropriately staff Sustainable Transportation efforts for the campus to oversee continual improvements, evaluation, and future planning at F&S
 - a) Continue to fund the full-time campus bicycle coordinator or similar position every year.
 - b) Allocate funding for at least one intern in F&S focusing on sustainable transportation.
2. Maintain appropriately staffed Campus Bike Center
 - a) Continue to fund the full-time staff to oversee operation at Campus Bike Center every year
 - b) Continue to allocate funding to support part-time and student employees at Campus Bike Center



State and National Resources

1. Continue to have an active member in Association of Pedestrian and Bicyclist Professionals
2. Continue to have an active member in League of American Bicyclists
3. Continue to work with Ride Illinois



Implementation: Projects



Existing Bicycle Network

University of Illinois Urbana-Champaign

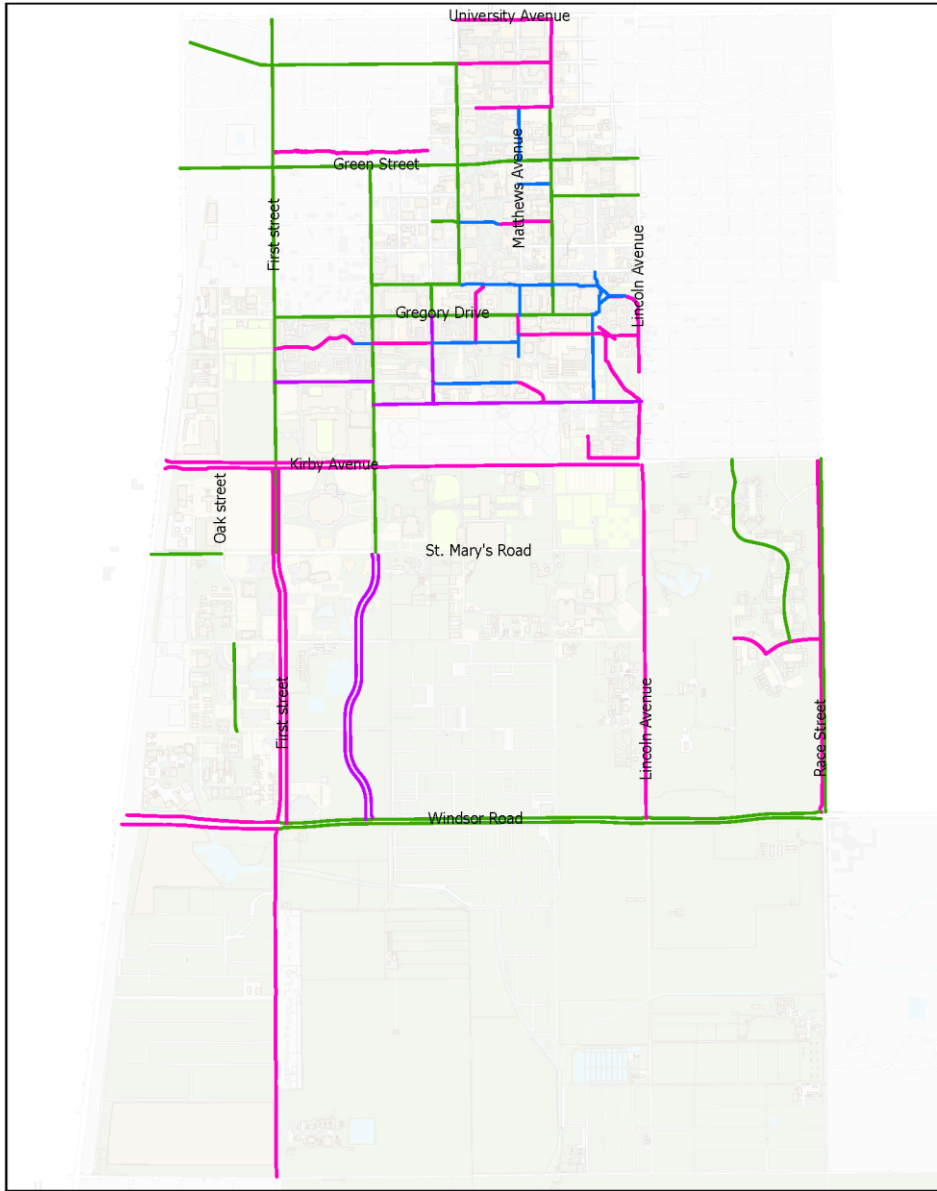
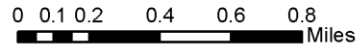

Bicycle Infrastructure Legend

- Bicycle Lane
- Bicycle Path
- Bicycle Sharrow
- Shared-Use Path



ation

Proposed Bicycle Network

University of Illinois Urbana-Champaign

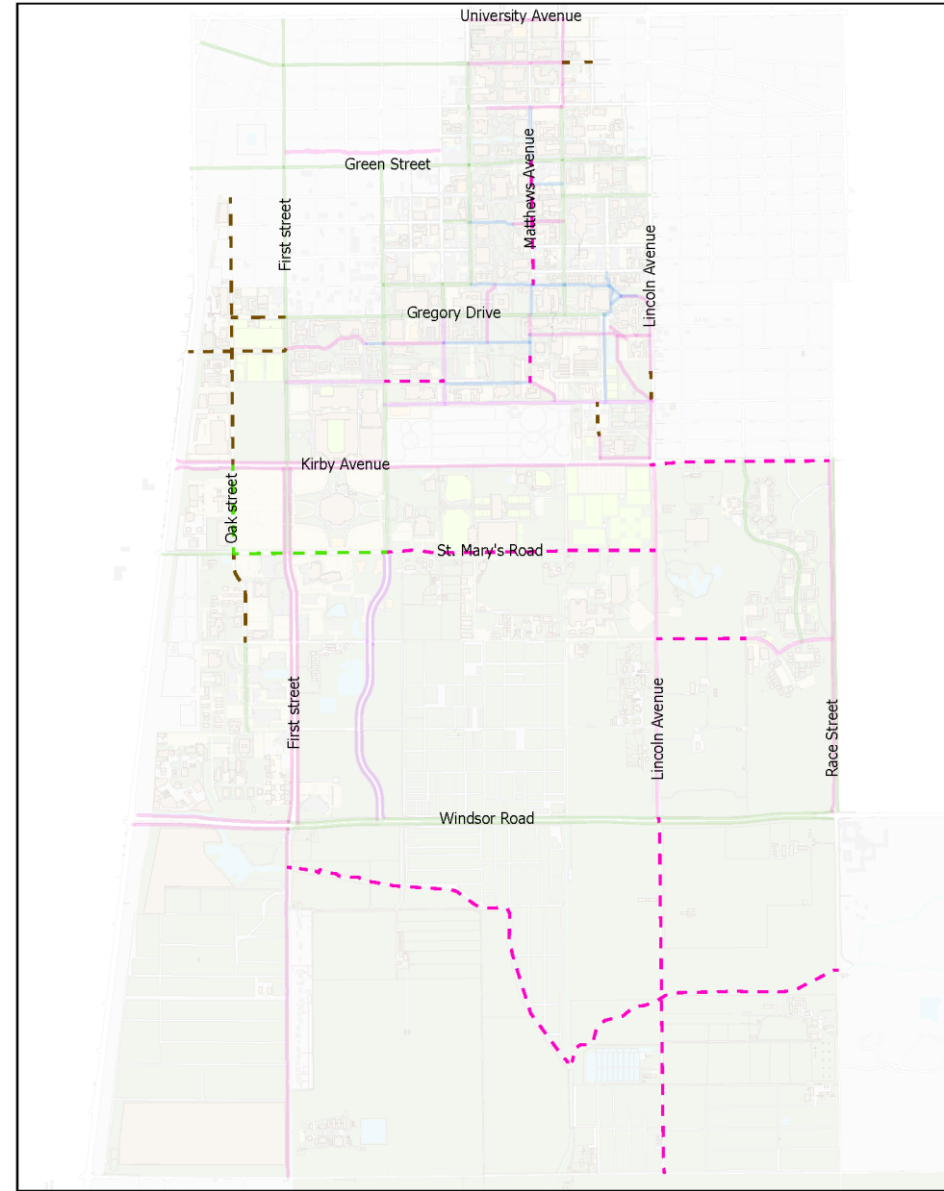
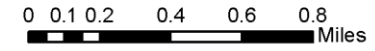

Bicycle Infrastructure Legend

- Bicycle Lane
- Bicycle Path
- Bicycle Sharrow
- Shared-Use Path
- - - Proposed Bicycle Lane
- - - Proposed Shared-Use Path
- - - Proposed Bicycle Route



Agility

Implementation priority list

High Priority Projects
• Florida Avenue
• Gregory Drive
• Mathews Avenue
• N-S Wood Engineering Lab
Medium Priority Projects
• Hazelwood Drive
• Oak Street
• Peabody Drive
• Stadium Drive
Low Priority Projects
• ACES Legacy Trail
• FAR/PAR Bicycle routes
• Main Street
• St. Mary's Road





High Priority

Unity



Facilities & Services

UNIVERSITY OF ILLINOIS URBANA-CHAMPAIGN

Florida Avenue shared-use path

- Proposed infrastructure:
 - 8' wide shared-use path on the South side of Florida Avenue connecting Lincoln Avenue and Race Street.

Florida Avenue

Proposed Bicycle Infrastructure

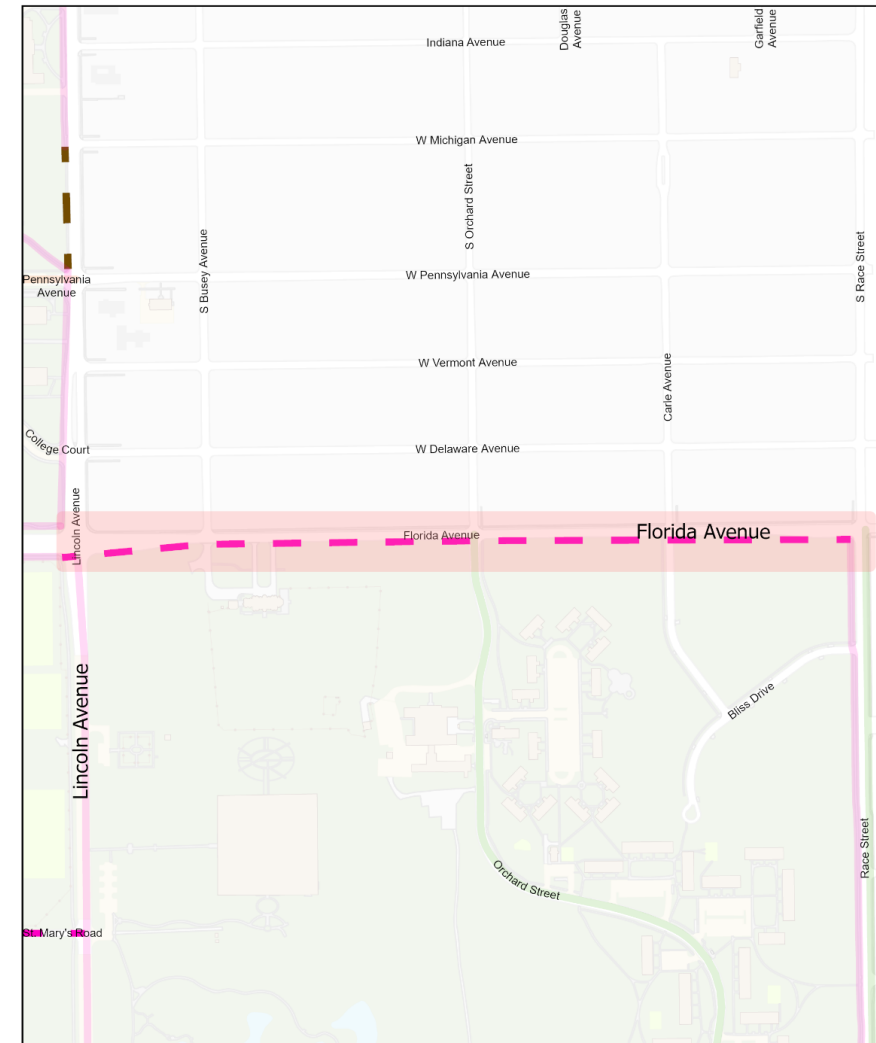
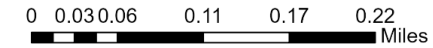

Bicycle Infrastructure Legend

- Bicycle Lane
- Bicycle Sharrow
- Shared-Use Path
- Proposed Bicycle Route
- - - Proposed Shared-Use Path
- Proposed project area



Gregory Drive bike route

- Proposed infrastructure:
 - Bike Route or Share the Road sign along Gregory Drive between First Street and Oak Street
- Note: Consider bike lanes

Gregory Drive
Proposed Bicycle Infrastructure

0 0.010.02 0.04 0.06 0.08 Miles



Bicycle Infrastructure Legend

- Bicycle Lane
- Shared-Use Path
- - - Proposed Bicycle Route
- Proposed project area



Mathews Avenue shared-use path (West side only)

- Proposed infrastructure:
 - Remove the existing bike path and sidewalk from this area
 - Add an 8' wide Shared-use Path along Mathews Avenue from Green Street to south of Smith Memorial Hall.
 - Covered bike parking at south of Lincoln Hall, west of Smith Memorial Hall, and north of Literatures, Cultures and Linguistics Building.

Mathews Avenue

Proposed Bicycle Infrastructure

0 0.01 0.03 0.06 0.09 0.12 Miles

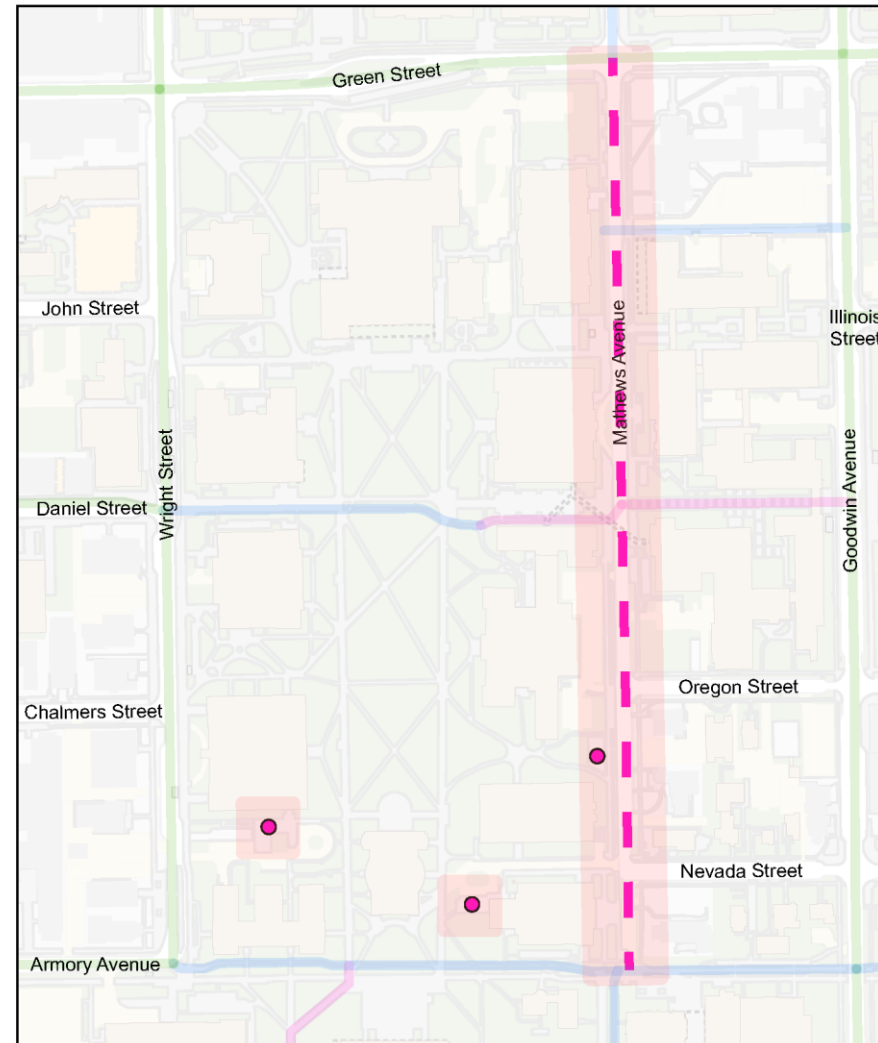

Bicycle Infrastructure Legend

- Bicycle Lane
- Bicycle Path
- - - Proposed Shared-Use Path
- Proposed Covered Bicycle Parking
- Proposed project area



70



Facilities & Services
UNIVERSITY OF ILLINOIS URBANA-CHAMPAIGN

Inspiration

Agility

N-S Wood Engineering Lab

- Proposed infrastructure:
 - 10' wide shared-use path
 - Solar cat's eyes lighting
 - (Potential) Pedestrian lighting along the new path

N-S Wood Engineering Lab

Proposed Bicycle Infrastructure

0 0.010.02 0.04 0.06 0.08 Miles

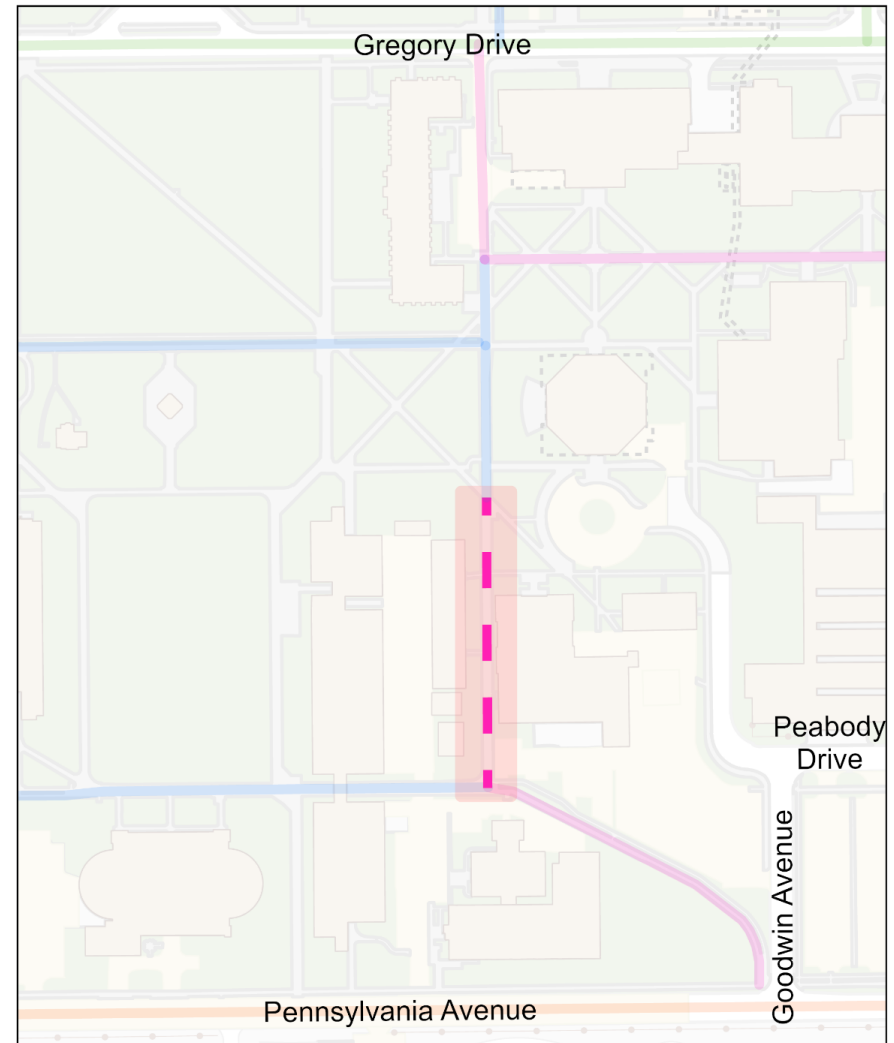

Bicycle Infrastructure Legend

- Bicycle Lane
- Bicycle Sharrow
- Bicycle Path
- Shared-Use Path
- - - Proposed Shared-Use Path
- Proposed project area



71



Facilities & Services
UNIVERSITY OF ILLINOIS URBANA-CHAMPAIGN

Inspiration

Agility

Medium Priority

Unity



Hazelwood Drive shared-use path

- Proposed infrastructure:
 - 8' wide shared-use path
 - Pedestrian lighting
 - In-pavement solar cat's eyes

Hazelwood Drive

Proposed Bicycle Infrastructure

0 0.01 0.03 0.06 0.09 0.12 Miles

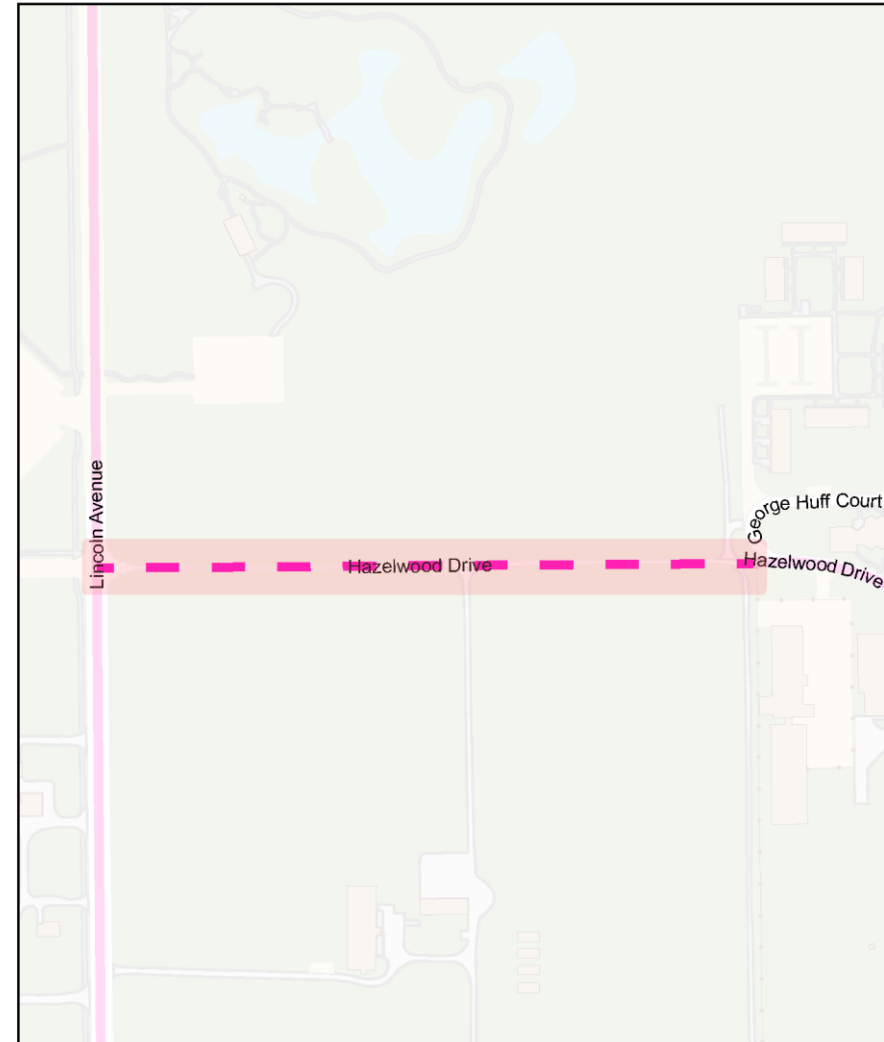

Bicycle Infrastructure Legend

- Shared-Use Path
- - - Proposed Shared-Use Path
- Proposed project area



73



Facilities & Services
UNIVERSITY OF ILLINOIS URBANA-CHAMPAIGN

Inspiratio

• Agility

Oak Street Bicycle Lane and Route

- Proposed infrastructure:
 - Add a bike route or share the road sign along Oak Street from John Street to Kirby Avenue.
 - Add a bicycle lane along Oak Street from Kirby Avenue to St. Mary's Road.
 - Add a bike route or share the road sign along Oak Street from St. Mary's Road to Gerty Drive.

Oak Street

Proposed Bicycle Infrastructure

0 0.05 0.1 0.2 0.3 0.4 Miles

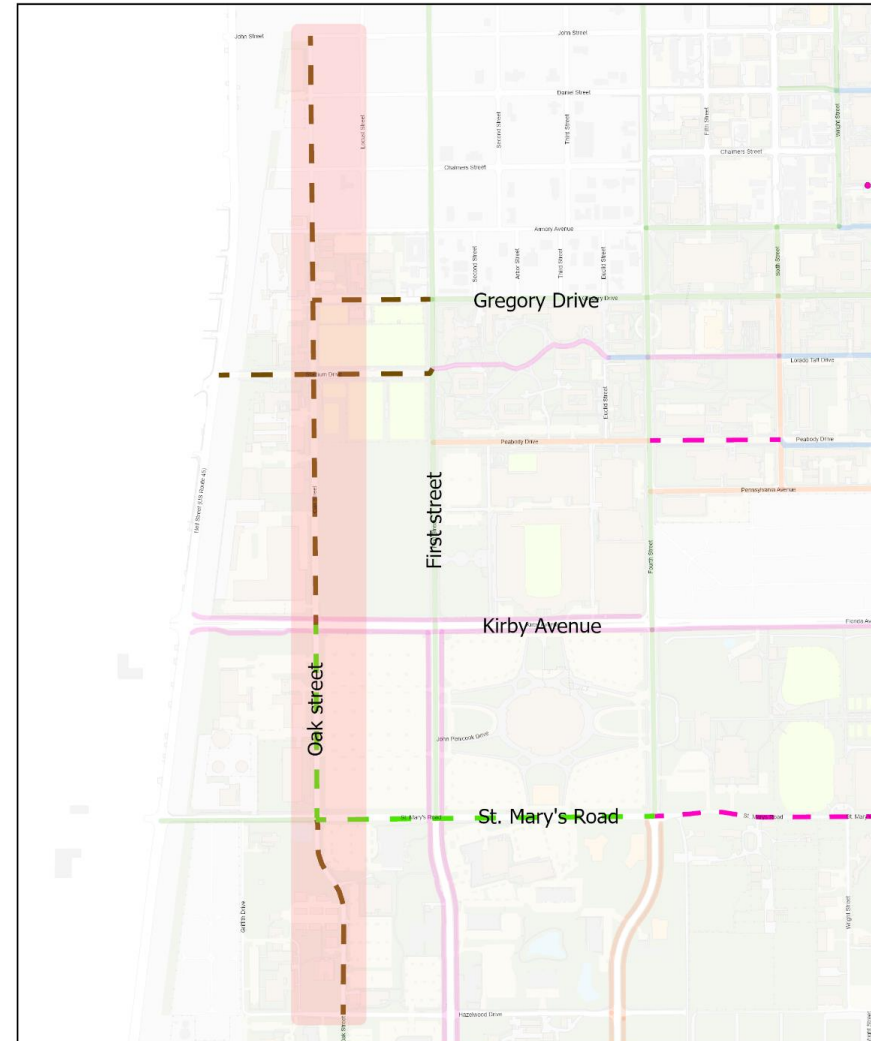

Bicycle Infrastructure Legend

- Bicycle Lane
- Bicycle Path
- Bicycle Sharrow
- Shared-Use Path
- Proposed Bicycle Lane
- Proposed Shared-Use Path
- Proposed Bicycle Route
- Proposed project area



Peabody Drive Shared-Use Path

- Proposed infrastructure:
 - Removal of existing bicycle path along Peabody Drive from Fourth Street to Sixth Street.
 - Add a shared-use path along Peabody Drive from Fourth Street to Sixth Street.

Peabody Drive

Proposed Bicycle Infrastructure

0 0.01 0.02 0.04 0.06 0.08 Miles

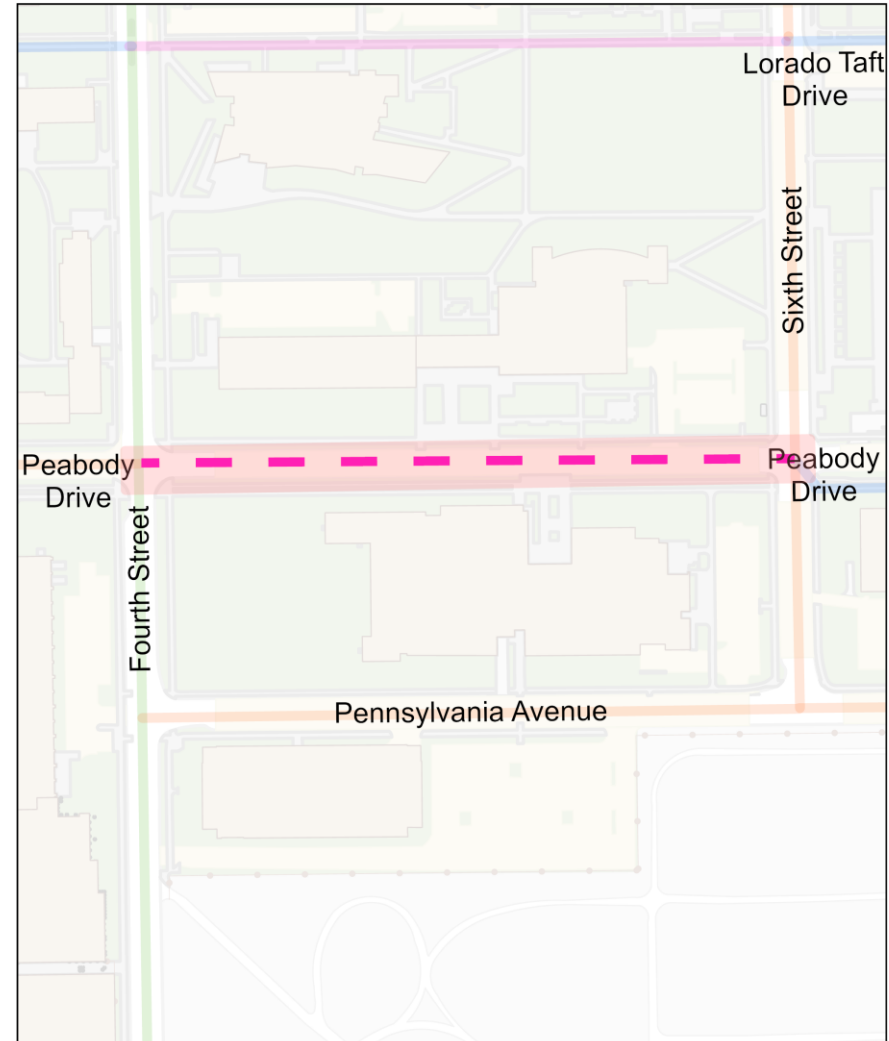

Bicycle Infrastructure Legend

- | | | |
|--------------|-----------------|--------------------------|
| Bicycle Lane | Bicycle Sharrow | Proposed Shared-Use Path |
| Bicycle Path | Shared-Use Path | Proposed project area |



75



Facilities & Services
UNIVERSITY OF ILLINOIS URBANA-CHAMPAIGN

Inspiration

Agility

Stadium Drive shared-use path

- Proposed infrastructure:
 - Add a bike route or share the road sign along Stadium Drive from Neil Street to First Street.

Stadium Drive
Proposed Bicycle Infrastructure

0 0.010.03 0.06 0.09 0.12 Miles

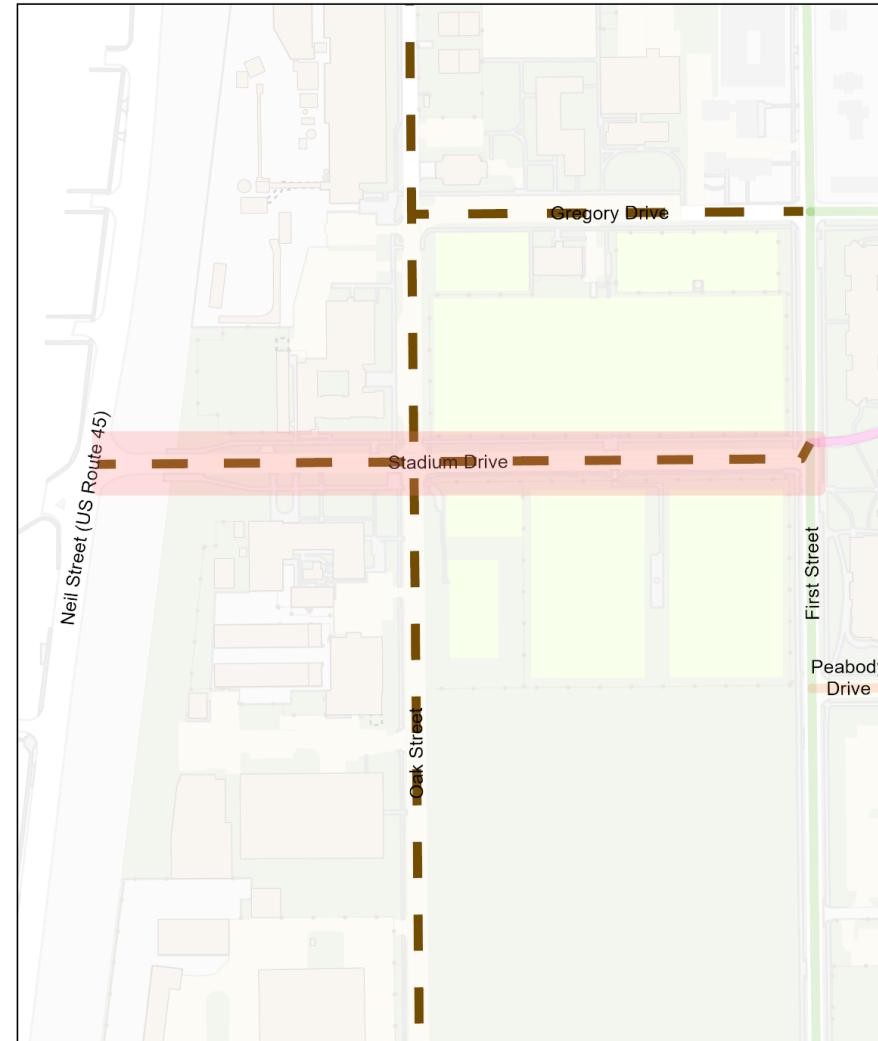

Bicycle Infrastructure Legend

- Bicycle Lane
- Shared-Use Path
- Bicycle Sharrow
- Proposed Bicycle Route
- Proposed project area



Low Priority



Facilities & Services

UNIVERSITY OF ILLINOIS URBANA-CHAMPAIGN

ACES Legacy Trail

- Proposed infrastructure:
 - 8' wide shared-use path
 - Pedestrian lighting
 - Landscape enhancement

ACES Legacy trail
Proposed Bicycle Infrastructure

0 0.070.15 0.3 0.45 0.6 Miles



Bicycle Infrastructure Legend

- Bicycle Lane
- Bicycle Sharrow
- Shared-Use Path
- - - Proposed Shared-Use Path
- Proposed project area



Main Street Bike Route

- Proposed infrastructure:
 - Remove the existing bike path and sidewalk from this area
 - Add a bike route or share the road sign along Main Street from Goodwin Avenue to Harvey Street.
 - Covered bike parking to the west of Matthews Avenue near Transportation Building.

Main Street

Proposed Bicycle Infrastructure

0 0.010.03 0.05 0.08 0.1 Miles

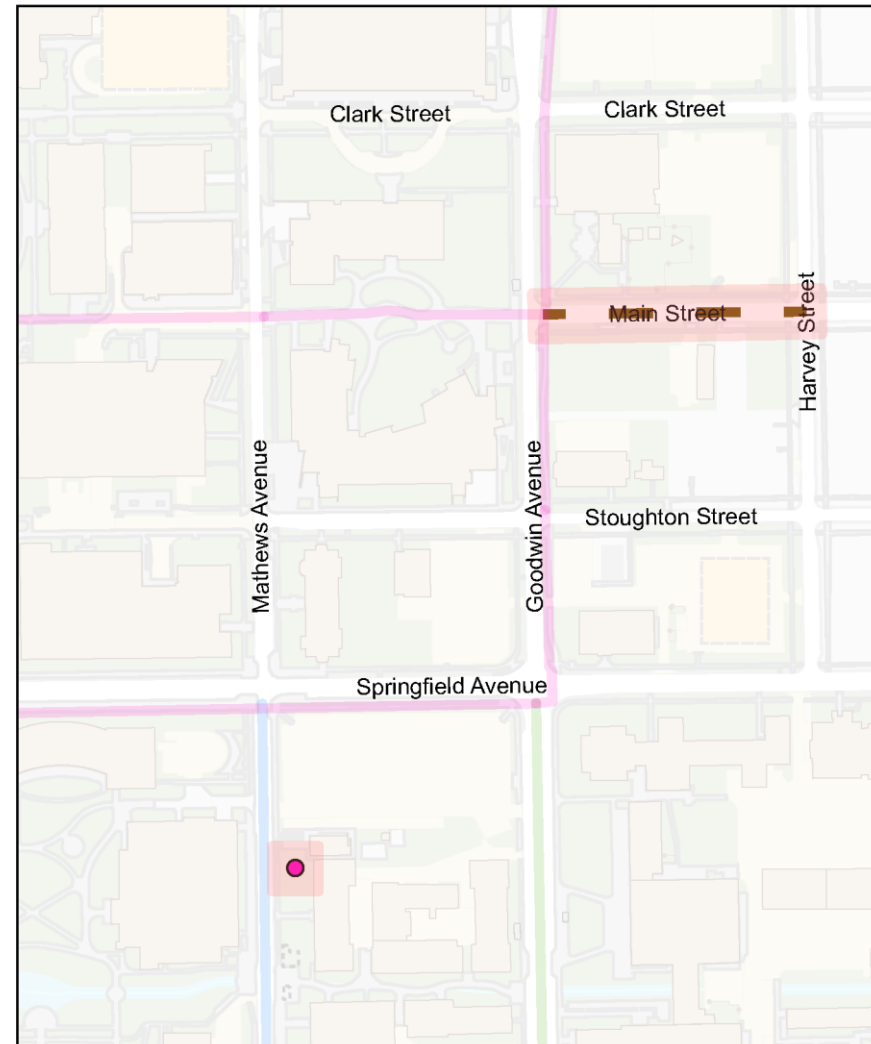

Bicycle Infrastructure Legend

- Bicycle Lane
- Bicycle Path
- Shared-Use Path
- Proposed Bicycle Route
- Proposed Covered Bicycle Parking
- Proposed project area



St. Mary's Road Bicycle Lane and Shared-use Path

- Proposed infrastructure:
 - Add a bicycle lane along St. Mary's Road from Oak Street to Fourth Street.
 - Add an 8' wide shared-use path along St. Mary's Road from Fourth Street to Lincoln Avenue.

St. Mary's Rd

Proposed Bicycle Infrastructure 0 0.07 0.15 0.3 0.45 0.6 Miles

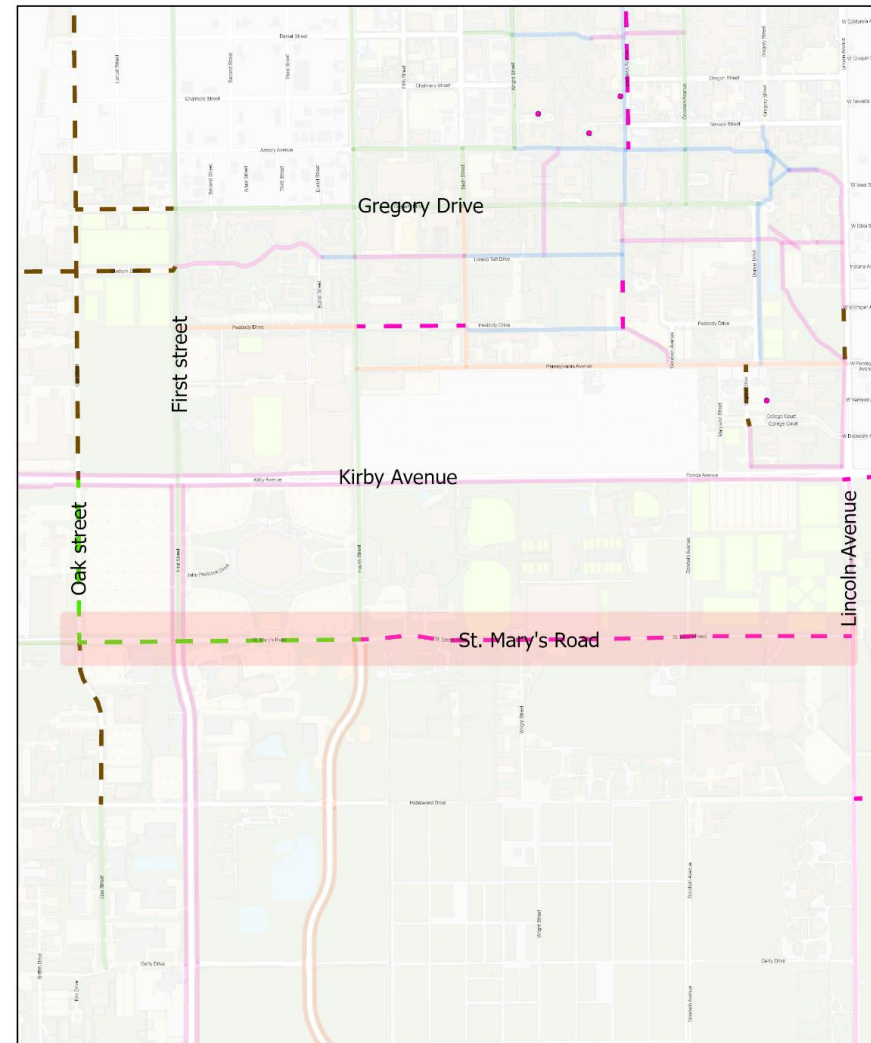

Bicycle Infrastructure Legend

- | | | |
|-----------------|--------------------------|----------------------------------|
| Bicycle Lane | Shared-Use Path | Proposed Bicycle Route |
| Bicycle Path | Proposed Bicycle Lane | Proposed Covered Bicycle Parking |
| Bicycle Sharrow | Proposed Shared-Use Path | Proposed project area |



Discussion



Agenda

- Introduction – Mohamed Sultan (5 minutes)
- Old Business
 - F&S TDM Status Update – Stacey DeLorenzo and Sarthak Prasad (20 minutes)
 - ADA Transition Plan project updates – Sarthak Prasad (10 minutes)
 - 2024 Campus Bicycle Plan: Goals and Objectives and Infrastructure projects – Sarthak Prasad (45 minutes)
 - **Bike Share Updates– Sarthak Prasad (5 minutes)**
- Community Updates – (5 minutes)



Bike Share Updates



Bike Share updates

- Veo
 - Operation restarted following winter break
 - Testing new off bike rack locations for ending bike rides
 - 750 bikes in the market
- Bird bike share
 - Contract signed
 - Starting operation soon
 - 500 class-1 e-bikes only



Agenda

- Introduction – Mohamed Sultan (5 minutes)
- Old Business
 - F&S TDM Status Update – Stacey DeLorenzo and Sarthak Prasad (20 minutes)
 - ADA Transition Plan project updates – Sarthak Prasad (10 minutes)
 - 2024 Campus Bicycle Plan: Goals and Objectives and Infrastructure projects – Sarthak Prasad (45 minutes)
 - Bike Share Updates– Sarthak Prasad (5 minutes)
- **Community Updates – (5 minutes)**



Community Updates



Thank you!

Contact F&S TDM at:

fandscampustdm@illinois.edu

Stacey DeLorenzo

Sarthak Prasad

87



Facilities & Services

UNIVERSITY OF ILLINOIS URBANA-CHAMPAIGN