



STUDENT SUSTAINABILITY COMMITTEE

Funding Application – Step II

Funding Criteria

A. General Rules

1. Students, faculty, and staff are encouraged to submit requests for funding. Student-led projects require a faculty or staff sponsor in order to have funds awarded.
2. Funding can only go to university-affiliated projects from students, faculty, staff, and departments.
3. All SSC projects must make a substantial impact on students. This may be a direct impact or an impact through education and engagement. All SSC funding is 100% from student green fees, so the projects funded by the students must benefit them.
4. SSC encourages innovation and new technologies – creative projects are encouraged to apply.
5. Unless a type of expense is specifically listed below as having restrictions, SSC can generally fund it. The items referenced below should not be taken as comprehensive list.

B. Things SSC Can Fund, On A Case-By-Case Basis

1. SSC can fund feasibility studies and design work; however, it must work toward ultimately addressing a sustainability need on campus.
2. SSC can fund staff positions that are related to improving campus sustainability. Strong preference will be given to proposals receiving matching funding from departments and/or plans for maintaining continuity of the position after the end of the initial grant.
3. SSC can fund outreach events with a central theme of sustainability, provided their primary audience is the general campus community.
4. SSC discourages funding requests for food and prizes but will consider proposals on a case by case basis that prove significant reasoning.
5. SSC can fund repairs and improvements to existing building systems as long as it works toward the goal of improving campus sustainability; however, a preference is shown to projects utilizing new or innovative ideas.
6. SSC can provide departments with loans for projects with a distinct payback on a case by case base. Loans will require a separate memorandum of understanding between SSC and departmental leadership pledging to repay the award in full and detailing the payback plan.

C. Things SSC Will Not Fund:

1. SSC will not fund projects with a primary end goal of generating revenue for non-University entities.
2. SSC will not fund personal lodging, food, beverage, and other travel expenses.
3. SSC will not fund any travel expenses.
4. SSC will not fund tuition or other forms of personal financial assistance for students beyond standard student employee wages.

Your Step 2 funding application should include this application, the supplemental budget form, and any letters of support.

Please submit this completed application and any relevant supporting documentation to Sustainability-Committee@illinois.edu. The Working Group Chairs will be in contact with you regarding any questions about the application. If you have any questions about the application process, please contact the Student Sustainability Committee at sustainability-committee@illinois.edu.

General & Contact Information

Project Name: Purchase and Install bike racks for Covered, Secure Bike Cage at ECE

Total Amount Requested from SSC: \$3,000.00

Project Topic Areas: Land & Water Education Energy
 Transportation Food & Waste

Applicant Name:

Campus Affiliation (Unit/Department or RSO/Organization):

Email Address:

Check one:

This project is solely my own **OR**

This project is proposed on behalf of (name of student org., campus dept., etc.):

Project Team Members

Name	Department	Email
Joyce Mast	Electrical & Computer Engineering (ECE)	jmast@illinois.edu
Sarthak Prasad	Facilities & Services	Sprasad9@illinois.edu
Stacey DeLorenzo	Facilities & Services	Sprasad9@illinois.edu
Catherine Somers	Assistant Head for Administration ECE	csomers@illinois.edu

Student-Led Projects (Mandatory):

Name of Faculty or Staff Project Advisor:

Advisor's Email Address:

Financial Contact (Must be a full-time University of Illinois staff member)

Contact Name: Mike Alsip

Unit/Department: Facilities & Services

Email Address: alsip@illinois.edu

Project Information

Please review the proposal materials and online content carefully. It is highly recommended you visit a working group meeting sometime during the proposal submission process.

Please provide a brief background of the project, its goals, and the desired outcomes:

You may copy and paste your Step 1 application answer if nothing has changed.

We can purchase the bike racks over the summer and install them in late summer or fall 2022.

Proposed Timeline: Fall 2022, per Sarthak Prasad, Facilities and Services.

Project Description

Two bike racks, one 3-loop and one 2-loop (see below), like those used across the UIUC campus, are to be installed inside a covered, secured bike cage attached to ECEB at the Wright Street loading-dock entrance. The loading dock area has security cameras. The cage includes a welded mechanism opened with a combination lock (see circled area in picture); the combination is only available to registered users. Ten bikes could be accommodated with the racks. At present, one to three bicyclists prop their bikes against the sides of the enclosure.

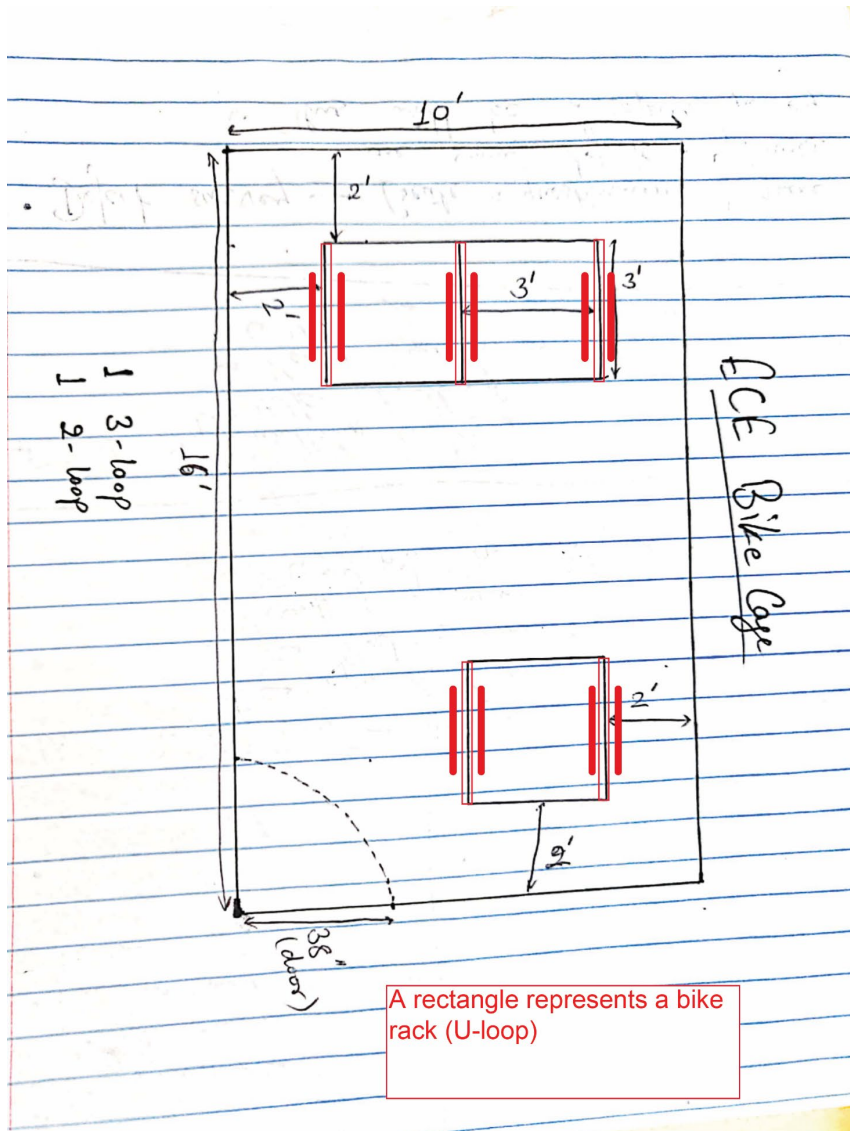

Scanned with CamScanner



Entrance to cage from ECEB loading dock (facing north)
Locked cage door is front right (lock is circled in red).



West side (front) of bike cage (facing east)

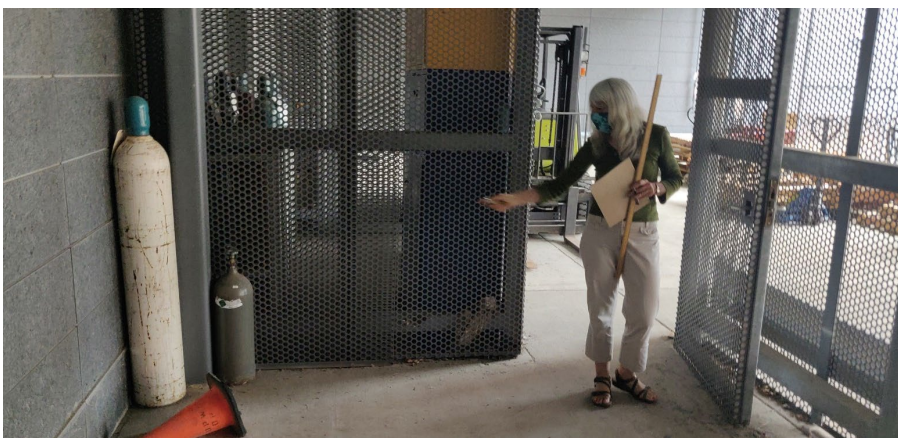

Entrance to bike cage from inside (facing south)

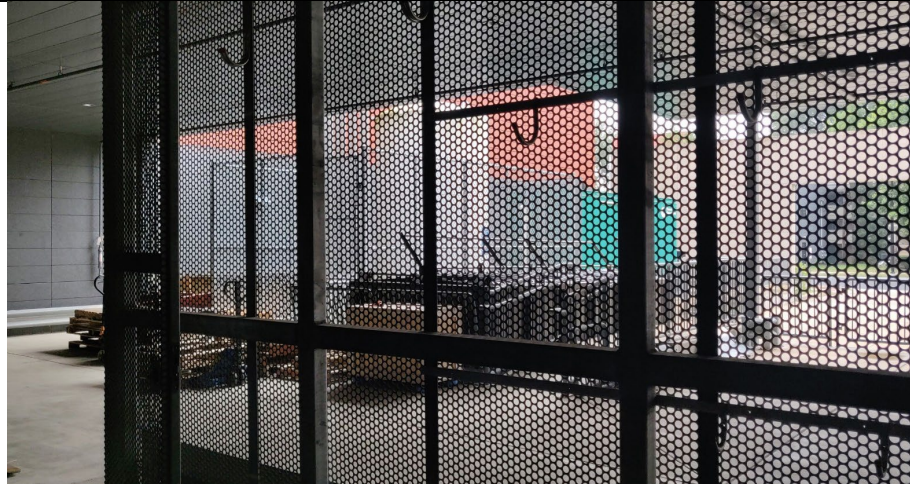

Inside bike cage looking southwest

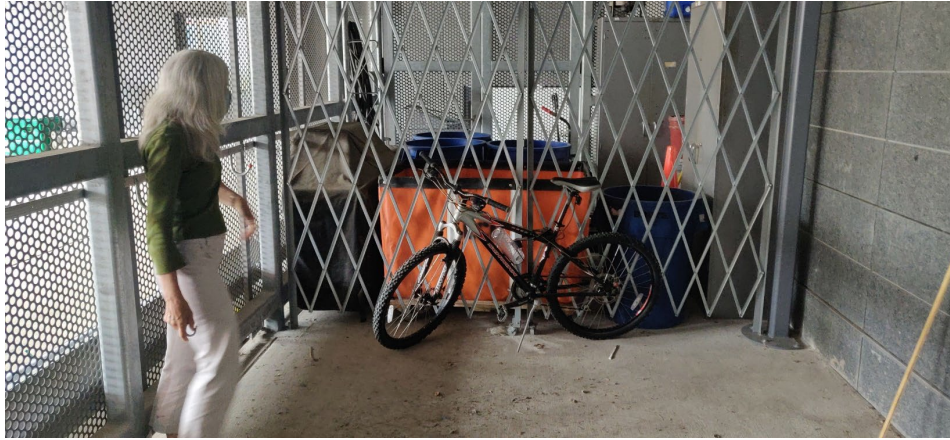

Inside the bike cage (facing north) with one bike propped against the divider. Space behind this bike is potentially available if there is sufficient demand.

We hope to encourage ECEB bicycle commuting throughout the year by being able to assure users that their bikes will be covered, secure and protected in a space available 24/7 that does not require entering ECEB. Facilities personnel have told us that if there is strong demand, the bike-parking cage can be enlarged (Potential adjacent space is being used for storage--see above). ECEB would be the first UIUC building with secure, covered bike parking for ten or more cyclists (NCSA has indoor parking with racks on the walls for a few commuters).

Where will the project be located? Are special permissions required for this project site?

If special permission is required for this location, please explain and submit any relevant letters of support with the application.

See project description above.

Other than the project team, who will have a stake in the project? Please list other individuals, groups, or departments affiliated directly or indirectly by the project. This includes any entity providing funding (immediate, future, ongoing, matching, in-kind, etc.) and any entities that benefit from this project.

We have the commitment from Catherine Somers (See above) that the ECE department will continue to support this project, as needed. We have received approval from the Facilities and Services and site manager.

How will this project involve and/or benefit students?

We hope to encourage ECEB bicycle commuting throughout the year by being able to assure users that their bikes will be covered, secure and protected in a space available 24/7 that does not require entering ECEB. Facilities personnel have told us that if there is strong demand, the bike-parking cage can be enlarged (Potential adjacent space is being used for storage--see above). ECEB would be the first UIUC building with secure, covered bike parking for ten or more cyclists (NCSA has indoor parking with racks on the walls for a few commuters).

How will you bring awareness and publicize the project on campus? In addition to SSC, where will information about this project be reported?

When racks are installed, this can be reported through ECE Wire, as well as on the iSEE website. And, if it helps UIUC obtain Bicycle Friendly Gold rating, it will also be on the transportation section of the iSEE website. We could also add bike riding as an option to save energy through our kiosks in the ECEB lobby.

Financial Information

In addition to the below questions, please submit the supplemental budget spreadsheet available on the Student Sustainability Committee [website](#). Submission of both documents by the submission deadline is required for consideration of your project.

Have you applied for funding from SSC before? If so, for what project?

Yes. We have received funding for ***Electrical and Computer Engineering Building (ECEB) Interactive, Energy Education/Production/Use Display***. \$17,573.08 of the \$30,000 awarded has been spent and project has been extended until March 2023.

If this project is implemented, will you require any ongoing funding required? What is the strategy for supporting the project in order to cover replacement, operation, or renewal costs?

Please note that SSC provides funding on a case by case basis annually and should not be considered as an ongoing source of funding.

No

Please include any other obtained sources of funding. Have you applied for funding elsewhere?

Please attach any relevant letters of support as needed in a separate document.

No

Environmental, Economic, and Awareness Impacts

How will the project improve environmental sustainability at the Urbana-Champaign campus? If applicable, how does this project fit within any of the [Illinois Climate Action Plan \(iCAP\)](#) goals?

There are two areas where this project advances UIUC environment stewardship:

- 1)** Moving in direction of a Gold-rated Bicycle Friendly Campus
- 2)** Increasing use of Clean Energy Sources by 15% in FY25 beyond the 23% from FY 20 (food calories consumed by bicyclists to power transportation, in place of CO₂-producing fuels)

In addition, bicycling, especially bicycle commuting while knowing their bike is secure, contributes to mental, physical and spiritual health of bicyclists and, by extension, to their peers and the University at large

How will you monitor and evaluate the project's progress and environmental outcomes? What short-term and long-term environmental impacts do you expect?

We expect green behavior of those folks using the covered secure bike racks, including new and current faculty who have been unwilling to ride because there was no covered, secure bike parking at ECEB.

What are your specific outreach goals? How will this project inspire change at UIUC?

I will speak about this in our 5901 Seminar on the opening day when faculty, staff and graduate students introduce themselves and their research. I always talk about bike-riding at this event and offer to hand out bike maps and answer bike questions. As grad students are paid employees, they would qualify to use the bike parking. Anything that makes it easier to ride bikes, inspires potential bike riders to change their behavior and get on their bikes.

When racks are installed, this can be reported through ECE Wire, as well as on the iSEE website. And, if it helps UIUC obtain Bicycle Friendly Gold rating, it will also be on the transportation section of the iSEE website. We could also add bike riding as a way to save energy through our kiosks in the ECEB lobby.

If applicable, how does this project impact environmental injustice or social injustice?

Anytime folks are riding their bikes as opposed to driving vehicles, we are increasing social justice, because we are saving and protecting the earth for all, even for those who will never ride a bike.