



STUDENT SUSTAINABILITY COMMITTEE

Semesterly Report

Thank you for your commitment to green initiatives at the University of Illinois. One of the ongoing requirements listed in the terms of the funding agreement for your project is the submission of semesterly reports with key information about your project. In addition to this form, please provide additional financial documentation and/or progress photos if available.

Please be as accurate as possible in describing the project (including possible setbacks or challenges in meeting the initial goals of the project). Not fully meeting your project's goals will not disqualify you from making future funding requests as long as your reports are as complete and accurate as possible. If you have any questions, please contact the Student Sustainability Committee, at sustainability-committee@illinois.edu.

Project Name: CornCrete

Date of Report Submission: 5/6/2019

Project Purpose:

The Project will divert an agricultural waste product and direct it into a higher value end product: An insulating monolithic wall material.

Detailed Accounting of Expenditures to Date:

To Date the Project has incurred the following expenses:

Menards: \$13.67

Masks Duct Tape etc: \$70.82

Bale of Corn Stover: \$45

Undergrad Labor: \$144

Grad Labor: \$1,707.50

Work Comp:\$12.91

Total to Date: \$1993.90

Balance to Date \$4,5006.1

Project Progress to Date:

The majority of the work to date can be broken down into the following categories:

Design Work: Approx. 45.30 hrs

Material Preparation: Approx. 37 hrs

This semester we built a mock up wall. However, it took longer than expected so we are a little behind schedule. Also, for work to begin on the Weigh Station project F&S have had to be engaged as there are a number of services that need to be terminated or re-routed. These

conversations have already begun and hopefully some of the work can begin early in the summer so the “grasscrete” can be installed towards the end of the summer and early Fall.

Student Involvement and Outreach to Date:

All the work carried out to date which has incurred an expense has been the work of one undergraduate and one graduate student. This semester a team of 4 graduate students built a mock-up wall using 3 different agricultural fibers within the setting of a seminar class.

Marketing and Promotion Efforts to Date:

The project was discussed in an interview conducted by Jenna Kurtzweil, iSEE Communications Intern and released via the iSEE website on February 14th 2019:

[https://sustainability.illinois.edu/past-present-and-future-corncrete.](https://sustainability.illinois.edu/past-present-and-future-corncrete)

Additional Comments:

Drawings have now been produced to identify how three different agricultural fibers will be installed in walls of a structure in which agricultural fiber will be dried and measured for scientific research purposed. The addition of the “grasscrete” walls will make the working conditions for the student researchers more desirable – (warmer, as measurements are typically taken during the winter months). During the summer the team will access the feasibility of repairing and using “grasscrete” in Building 931.



Building 931
(first building to have CornCrete installed)

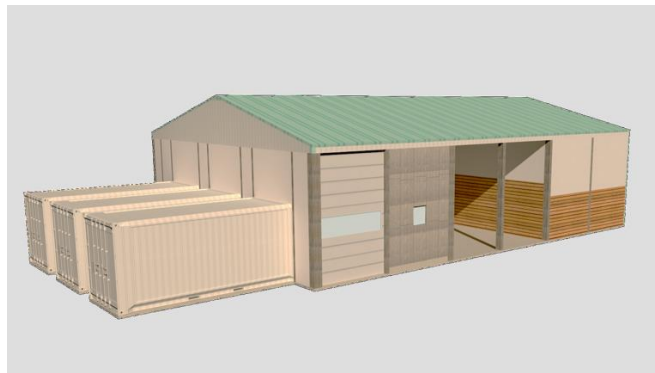

South side of barn will receive Corn Crete (summer 2019)